

PHILIPS

Replacement
shaving heads

Shaver series 9000
and SP900

Precision blades*

Fits S9000 (S9xxx)

Fits S9000 Prestige (SP98xx)



SH91/50



Reset your shaver to new

Change heads every 2 years for 100% performance

Within two years, your shaver heads cut 9 million hairs on your face. Replace the shaver heads and get back to 100% performance.

Compatibility

- Compatible with S9000 and S9000 Prestige

Powerful shaver, gentle on skin

- Advanced precision for a closer shave*

Easy to use

- Reset your shaver very simply
- Replace the shaver heads and get back to 100% performance

Highlights

Compatible with S9000

SH91 replacement heads are compatible with all Shavers Series 9000 (S9xxx) and S9000 Prestige (SP98xx).

Precision blades*



With up to 150.000 cutting actions per minute, the Precision blades* shave close. The 72 high-performance blades are self-sharpening and made in Europe.

Simple replacement

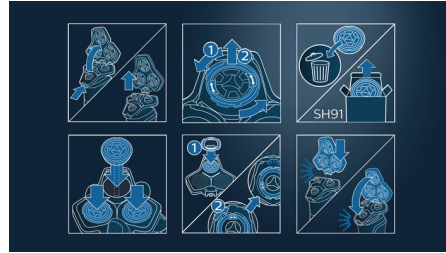

1. Press the release buttons and detach the shaving head holder.
2. Turn the retaining rings counterclockwise and remove them.
3. Remove old shaving heads and insert replacement (notches should fit exactly onto the projections).
4. Place retaining rings back and turn them clockwise until you hear a click.
5. Insert the shaving holder back and close.

Reset your shaver to new

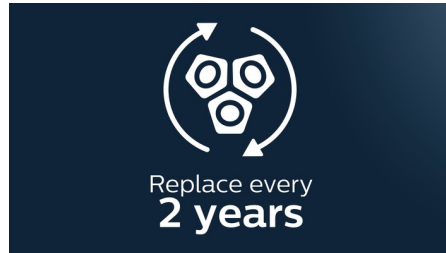

Replace the shaver heads and get back to 100% performance.

Specifications

Shaving heads

Fits product type: Shaver series 9000 (S9xxx), and S9000 Prestige (SP98xx)
Shaving heads per packaging: 3

