

ULPC-M product information sheet

Product Specifications

Fits most: 23" - 42" flat panels

Supports up to: 100 lbs (45.4 kg)

Tilt: -5° to +15°

Mounting profile: 2.36" (60mm)*

Maximum extension: 21.57" (548mm)*

VESA compliant: 100x100 to 400x400

Mounting: Single-stud

Warranty: 5 years

Color: Black

*Adapter adds 0.31" (8mm)

Product Benefits

- Arms completely nest for a discreet 2.4" (60mm) mounting profile
- Tilt, pan and swivel for maximum viewing flexibility
- Steel tube construction for maximum strength and durability
- Rack and pinion tilt mechanism for effortless adjustment
- Integrated cable management with quick-snap covers guide wires
- Built-in screen leveling
- Lift n' Lock™ allows you to easily attach your flat panel to the mount
- Sliding on-wall adjustment (2" lateral; 1.4" vertical)
- Locking system secures panel to mount
- Wall plate covers conceal mounting hardware
- Installation template for simple and accurate mounting
- Interchangeable cable covers for a customized look (available as an accessory)
- Includes complete hardware kit



Series



Full Motion Mounts

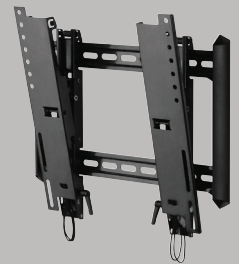

Tilt Mounts

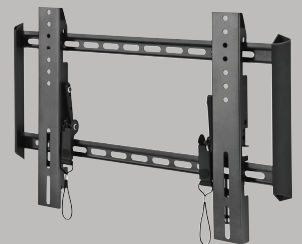

Fixed Mounts



With OmniMount's low profile full motion mounts, you get everything you want in one mount – the functionality and versatility of a full motion mount in a compact and discreet design.



OmniMount, an innovator of A/V mounts and furniture for more than a quarter century, is the choice of professional installers and the brand most recommended by flat panel manufacturers. The Ultra Low Profile Series of fixed, tilt and full motion mounts offers a sleek and slim design without compromising functionality. With an impressively low 2.4" (60mm) mounting profile, the ULPC-M is a medium full motion mount perfectly suited for those applications where seamless integration counts most.



ULPC-M technical data sheet



OmniMount, an innovator of A/V mounts and furniture for more than a quarter century, is the choice of professional installers and the brand most recommended by flat panel manufacturers. The Ultra Low Profile Series of fixed, tilt and full motion mounts offers a sleek and slim design without compromising functionality. With an impressively low 2.4" (60mm) mounting profile, the ULPC-M is a medium full motion mount perfectly suited for those applications where seamless integration counts most.



Fits most: 23" - 42" flat panels

Supports up to: 100 lbs (45.4 kg)

Tilt: -5° to +15°

Mounting profile: 2.36" (60mm)*

Maximum extension: 21.57" (548mm)*

VESA compliant: 100x100 to 400x400

Mounting: Single-stud

Warranty: 5 years

Color: Black

*Adapter adds 0.31" (8mm)

- Arms completely nest for a discreet 2.4" (60mm) mounting profile
- Tilt, pan and swivel for maximum viewing flexibility
- Steel tube construction for maximum strength and durability
- Rack and pinion tilt mechanism for effortless adjustment
- Integrated cable management with quick-snap covers guide wires
- Built-in screen leveling
- Lift n' Lock™ allows you to easily attach your flat panel to the mount
- Sliding on-wall adjustment (2" lateral; 1.4" vertical)
- Locking system secures panel to mount

- Wall plate covers conceal mounting hardware
- Installation template for simple and accurate mounting
- Interchangeable cable covers for a customized look (available as an accessory)
- Includes complete hardware kit

	Stock Code	Packaging UPC	MC UPC
Americas	1004536-1	728901023743	728901717192
International	1004536INT-1	728901023743	728901717192

	Dimensions WxDxH Inches (mm)	Wt lbs (kg)
Product Box	16.9 x 23 x 11.9 (430x585x303)	36.6 (16.6)
Master Carton	TBD	TBD

Box Contents	Qty
Monitor plate	1
Cantilever arm	1
Wall rail	2
Wall rail cover	2
Wing adapter	4

Box Contents	Qty
Cable cover	3
Complete mount installation hardware kit	1
Complete panel attachment hardware kit	1
Installation template	1
Instruction manual	1

ULPC-M line drawing

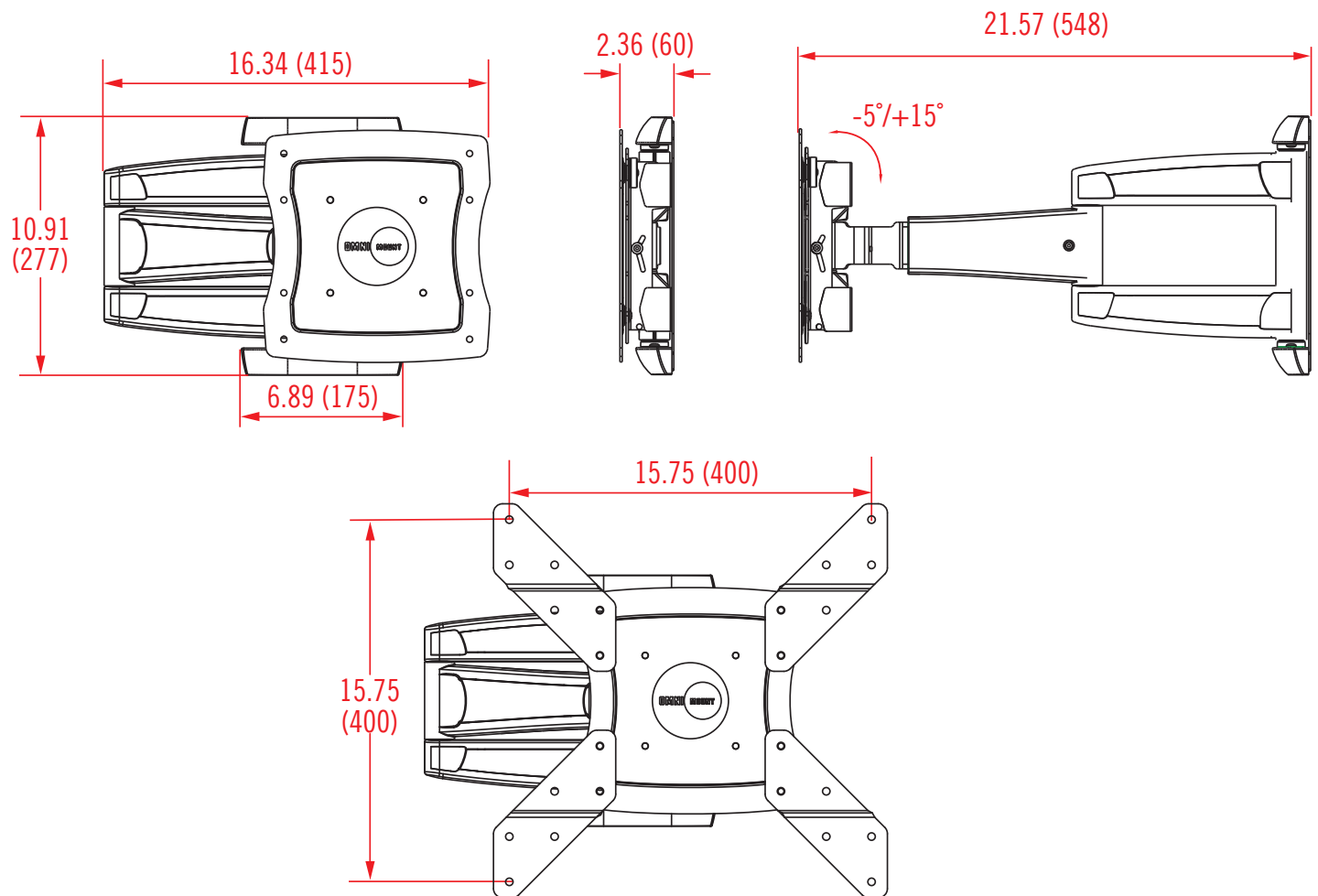

inches (mm)

LPHDM-C product information sheet

Product Specifications

Fits most: 23" - 42" flat panels

Supports up to: 100 lbs (45.4 kg)

Tilt: -5° to +15°

Mounting profile: 2.36" (60mm)*

Maximum extension: 21.57" (548mm)*

VESA compliant: 100x100 to 400x400

Mounting: Single-stud

Warranty: 5 years

Color: Black

*Adapter adds 0.31" (8mm)



Product Benefits

- Arms completely nest for a discreet 2.36-inch (60mm) mounting profile
- Tilt, pan and swivel for maximum viewing flexibility
- Steel tube construction for maximum strength and durability
- Rack and pinion tilt mechanism for effortless adjustment
- Integrated cable management with quick-snap covers guide wires
- Built-in screen leveling
- Lift n' Lock™ allows you to easily attach your flat panel to the mount
- Sliding on-wall adjustment (2" lateral; 1.4" vertical)
- Locking system secures panel to mount
- Wall plate covers conceal mounting hardware
- Installation template for simple and accurate mounting
- Interchangeable cable covers for a customized look (available as an accessory)
- Includes complete Grade 5 hardware kit



With OmniMount's low profile cantilevers, your customers will get everything they want in one mount – the functionality and versatility of a full motion mount in a compact and discreet design.

Series



Cantilever Mounts

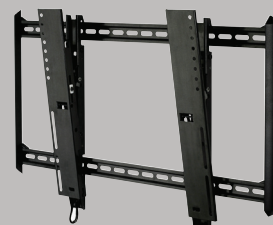

Tilt Mounts

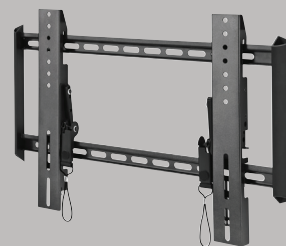

Fixed Mounts



Dedicated to being a one-stop shop for professional products, OmniMount remains on the cutting edge of product innovation. That's why we're the natural choice for any professional, industrial or commercial application. The Low Profile Series of fixed, tilt and cantilever mounts offers a sleek and slim design without compromising functionality. With an impressively low 2.36-inch (60mm) mounting profile, the LPHDM-C is a medium cantilever mount perfectly suited for those applications where seamless integration counts most.



LPHDM-C technical data sheet



Dedicated to being a one-stop shop for professional products, OmniMount remains on the cutting edge of product innovation. That's why we're the natural choice for any professional, industrial or commercial application. The Low Profile Series of fixed, tilt and cantilever mounts offers a sleek and slim design without compromising functionality. With an impressively low 2.36" (60mm) mounting profile, the LPHDM-C is a medium cantilever mount perfectly suited for those applications where seamless integration counts most.



Product Specifications

Fits most: 23" - 42" flat panels

Supports up to: 100 lbs (45.4 kg)

Tilt: -5° to +15°

Mounting profile: 2.36" (60mm)*

Maximum extension: 21.57" (548mm)*

VESA compliant: 100x100 to 400x400

Mounting: Single-stud

Warranty: 5 years

Color: Black

*Adapter adds 0.31" (8mm)

Product Benefits

- Arms completely nest for a discreet 2.36" (60mm) mounting profile
- Tilt, pan and swivel for maximum viewing flexibility
- Steel tube construction for maximum strength and durability
- Rack and pinion tilt mechanism for effortless adjustment
- Integrated cable management with quick-snap covers guide wires
- Built-in screen leveling
- Lift n' Lock™ allows you to easily attach your flat panel to the mount
- Sliding on-wall adjustment (2" lateral; 1.4" vertical)
- Locking system secures panel to mount
- Wall plate covers conceal mounting hardware
- Installation template for simple and accurate mounting
- Interchangeable cable covers for a customized look (available as an accessory)
- Includes complete Grade 5 hardware kit

	Stock Code	Packaging UPC	MC UPC
Americas	1004548-1	728901023958	728901717406
International	NA	NA	NA

	Dimensions WxDxH Inches (mm)	Wt lbs (kg)
Product Box	16.9 x 23 x 11.9 (430x585x303)	36.6 (16.6)
Master Carton	TBD	TBD

Box Contents	Qty
Monitor plate	1
Cantilever arm	1
Wall rail	2
Wall rail cover	2
Wing adapter	4

Box Contents	Qty
Cable cover	3
Complete mount installation hardware kit	1
Complete panel attachment hardware kit	1
Installation template	1
Instruction manual	1

LPHDM-C line drawing

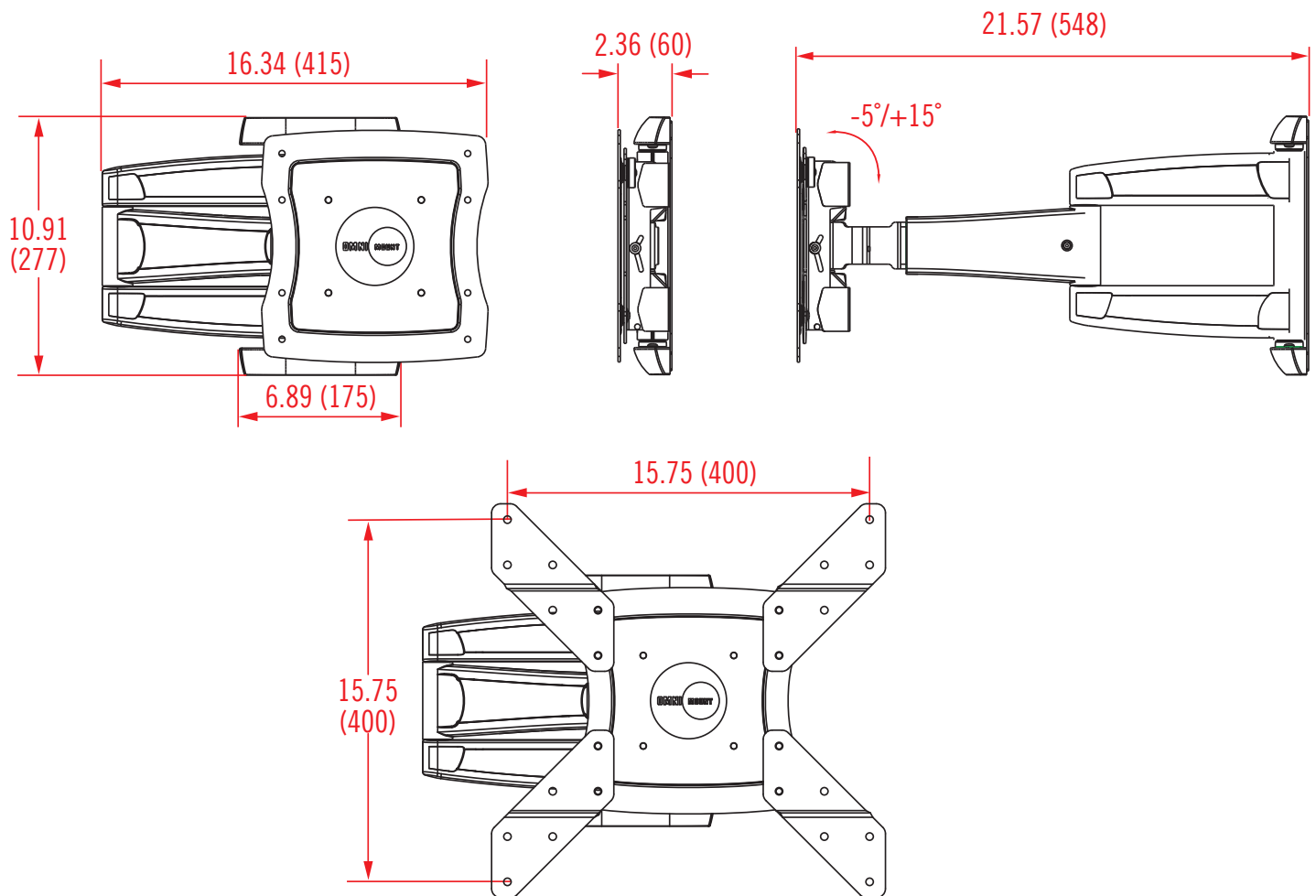

inches (mm)

Architects Specifications

The flat panel wall mount shall be an OmniMount model LPHDM-C and shall be located where indicated on the plans. It shall be constructed of sheet metal with $-5^{\circ}/+15^{\circ}$ adjustable tilt. Assembly and installation shall be done according to instructions provided by the manufacturer.