

# DCM250 product information sheet



The DCM250 is a sturdy double TV ceiling mount with universal adapter that allows TVs or digital signage to be seen from multiple locations. Our professional-grade ceiling mounts provide single or back-to-back mounting options.

## Product Benefits\*

- Supports two TVs for back-to-back mounting
- Portrait or landscape orientation
- Includes universal adapter for greater VESA compatibility
- Tension adjustment for variable tilt or locking pin mechanism for precise positioning
- Integrated cable management routes cables through NPT pipe and ceiling plate
- Lift n' Lock™ for quick installation
- Includes 24" of 1.5" NPT
- Threaded bottom pipe for additional accessories
- Includes ceiling plate
- Anti-theft security feature
- Includes Grade 5 hardware kit
- NPT extension pipes available in 12", 18" and 24" lengths

## Product Specifications\*

**Fits most:** 32–65" TVs/displays

**Supports up to:** 250 lbs (113.4 kg)

**Tilt:** Up to +25°

**VESA compliance:** 200x100 to 600x400

**Warranty:** 5 years

**Color:** Black



The DCM250 is equipped with a pin tilt mechanism that tilts the TV at precise increments, making the mount well-suited for single or multiple TV installations.

\*Subject to change

**800.MOUNT.IT (800.668.6848)**

## Series



SCM125



DCM250



10082012

# DCM250 technical data sheet

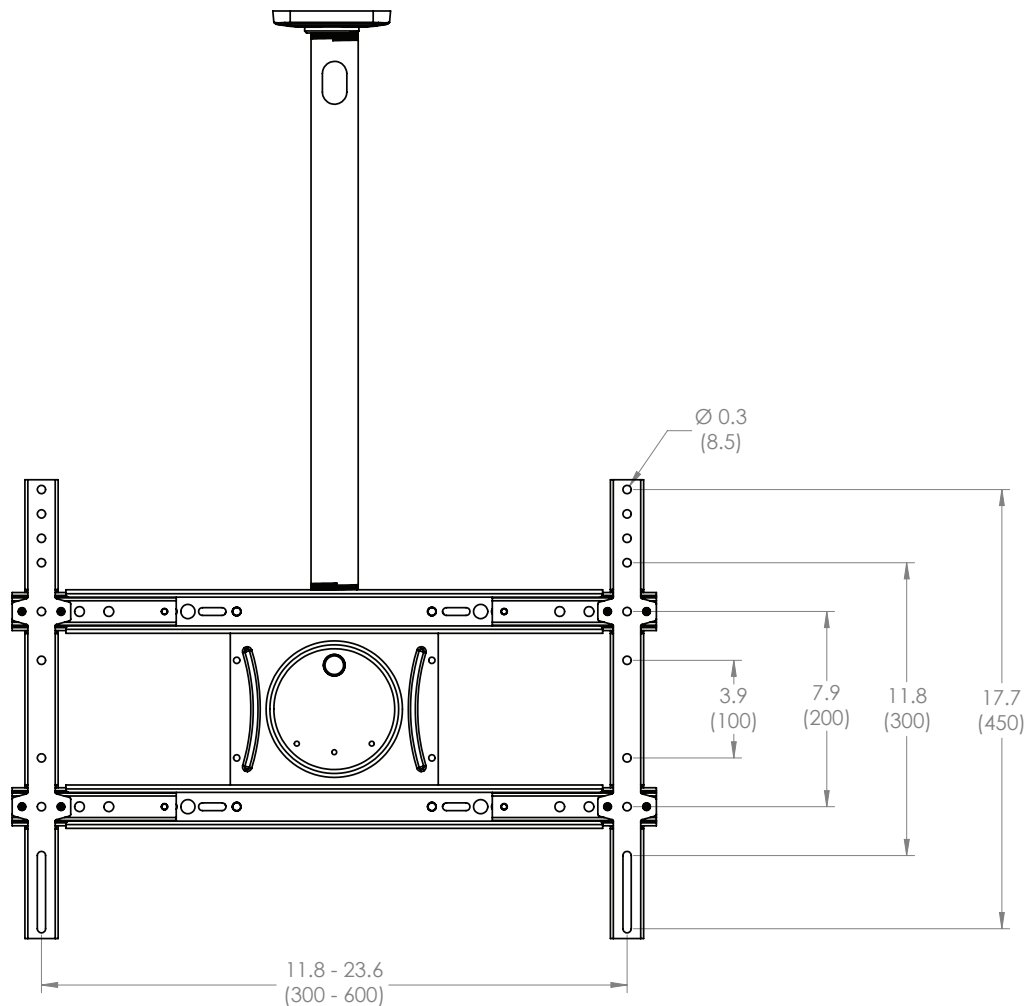

inches (mm)

	Packaging UPC	MC UPC
Americas	698833022940	NA
International	698833022940	NA

	Dimensions WxDxH Inches (mm)	Wt lbs (kg)	Qty
Box	24.4 x 27 x 5.1 (620x687x130)	39 (17.7)	NA
MC	NA	NA	NA

Box Contents	Qty
Ceiling plate	1
NPT pipe	1
Tilt hanger	2
Universal adapter	2
VESA plate	2

Box Contents	Qty
Monitor kit	2
Ceiling kit	1
Instruction manual	1
Complete hardware kit	1

