

SAS-ALARM300

Dual Networks Alarm System

User Manual

Table of Contents

Features	01
Package List	02-03
Control Panel Layout	04-05
Preparation before Use	06-07
Power on	06
Connect PSTN Land Line	06
Insert a SIM Card	07
Control Panel Operation	08-11
Alarm Control	08
Access Control System	10
Make Phone Calls	10
Voice Memo	11
Function Setting	11
Security Alarm Function	12-23
Test Accessories	12
Remote Control	
Appearance	12
Arm	13
Disarm	13
Home Arm (Partial Arm)	13
Mute Operation	14
SOS	14
Door/Window Contact	
Appearance	15
Test	16
Installation	16
Pet-Immune PIR Motion Detector	
Appearance	17
Working Mode	18
Test	19
Installation	20
Installation Notices	22

LCD Display Contents	24-25
LCD Display Menu	26-28
Settings	29-40
1. Alarm Phone Number Setup	
Add Alarm Phone Number	29
Delete Alarm Phone Number	29
2. Add/Delete/Edit Accessories	
Add/Delete Remote Controls or Wireless Keypads	30
Add/Delete/Edit RFID Tags	30
Add/Delete/Edit Wireless Sensors	31
Test Mode	32
3. System Settings	
Date and Time	32
Entry and Exit Delay	33
Backlight Time	34
Timed Arm / Disarm	34
Edit Greeting Message	35
Line Cut Alarm	35
Keypad Tone	35
Access Code	36
Ringing Times for Remote Phone Control	37
Alarm Message	37
Siren Setup	37
User ID for CMS	40
Upload Arm Report	40
Upload Disarm Report	40
Reset	40
4. Check Event Logs	40
Connect to Electronic Lock	40
Connect to CMS	41-42
Add CMS Phone Number	41
Delete CMS Phone Number	41
User ID	41
Upload Arm/ Disarm Report to CMS Center	42

Remote Control Instruction	42-43
Answering Alarm Phone Call to Start Remote Control	42
Remote Control by Calling Fixed Phone Number	43
Remote Control by Calling SIM Card Number	43
SMS Operation	44-48
Disarm	44
Arm (Away Arm)	45
Home Mode (Part Arm)	46
Monitor	47
Recording Voice Memo	48
App Operation	49-56
Download and Install APP	49
Control through SMS	50
Control through GPRS Data	52
Maintenance	57
FAQ	58
Specifications	59-60
Disclaimer	61

Features

- 100% wireless configuration, D.I.Y. installation
- Stylish design with touch keypad
- LCD with guide menu, easy for programming
- Built-in 1,000,000 RF codes combination maintains high reliability
- Support 10 remote controls, 50 wireless sensors, and 50 RFID tags
- Store 6 alarm phone numbers
- 10 seconds voice memo and alarm voice message recordable
- Disarm by RFID tags and unlock the electronic door lock
- Support maximum 150 alarm event logs
- Make phone calls directly
- Duress code enables sending out alarm notification mutely
- One group of timing arm and disarm
- Support exit & entry delay
- Rename all zones and RFID tags
- Voice prompt during phone remote control
- Arming, disarming and recording voice memo via App through SMS or GPRS

Please read this user manual carefully.

Please kindly keep this user manual for your reference when necessary.

Package List

Control Panel x1

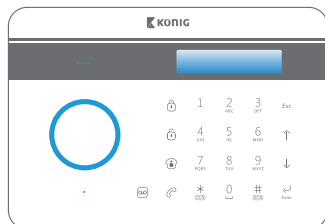

The control panel is known as the “heart and brain” for alarm system, which is used for receiving and processing signals from wireless sensors and remote controls. Users can make settings freely with the keypad and LCD display. In case of emergency, the panel hoots on site and dials the pre-stored alarm phone numbers automatically. When users pick up the phone, they are able to hear alarm voice message and choose to monitor on site or disarm the system. As a PSTN/GSM dual networks alarm system, the panel will switch to GSM network automatically to call the user for alert when the PSTN network is cut off.

Pet-Immune PIR Motion Detector x 1

Pet-Immune PIR Motion Detector is an intelligent passive infrared motion sensor, designed to detect human movements within an approximate range of 0 to 8 meters from the detector. The detector includes fuzzy logic to minimize false alarms from unwanted heat sources. With power saving feature, the detector will enter sleeping mode after the second activation within 3 minutes to save power.

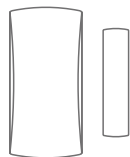
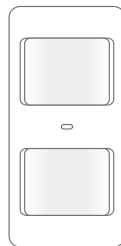

Wireless Door/Window Contact x 1

The Door/window contact can be installed on doors, windows and any other objects that open and close. The sensor transmits signals to the control panel when a magnet mounted near the sensor is moved away.



Wireless Remote Control x 2

The remote control is compact and portable; it is convenient to carry it to arm, disarm, part arm the alarm system and also make an emergency call.



RFID Tag x 2

The RFID tag is for disarming the system and unlocking the electronic door lock (if connected).

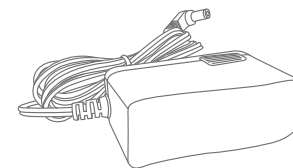

AC Adapter x 1

Supply power to the control panel. In case of power failure, two built-in backup batteries in the panel will support 5-hour standby.



Telephone Cable x 1

Connect PSTN land line to the control panel. In case of emergency, the panel will hoot on site and call the pre-stored alarm phone number to notify users.



Bracket for PIR Motion Detector x 1

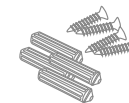

Screws and Wall Plugs x 4

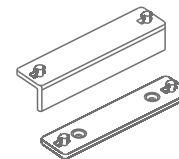

Brackets (Wall-Mounted and Desktop) for Control Panel x 2

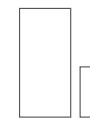

Double-Sided Tape for Door/Window Contact x 2

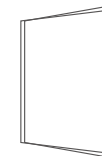

User Manual x 1

Control Panel Layout

Front Side

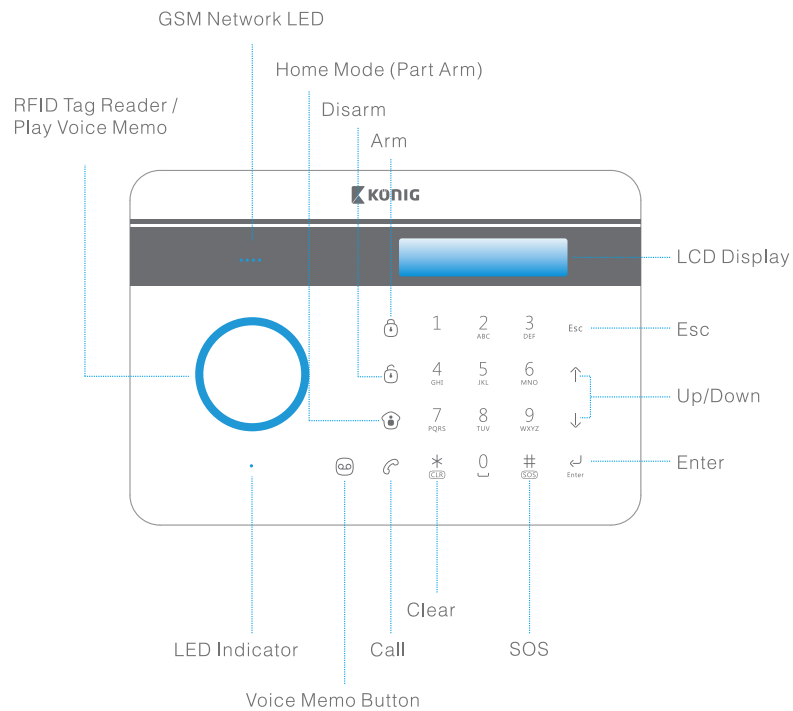

Rear Side

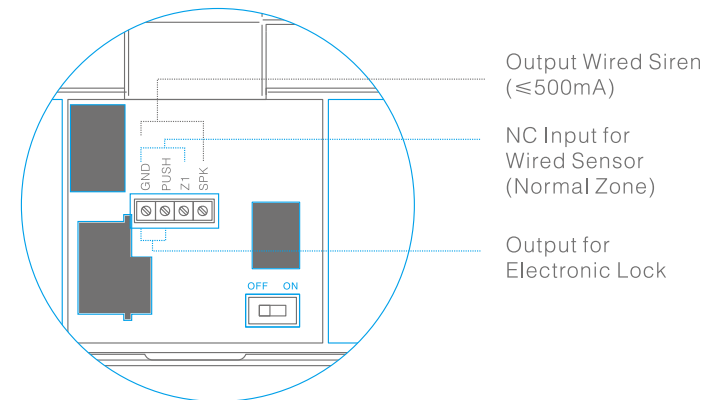
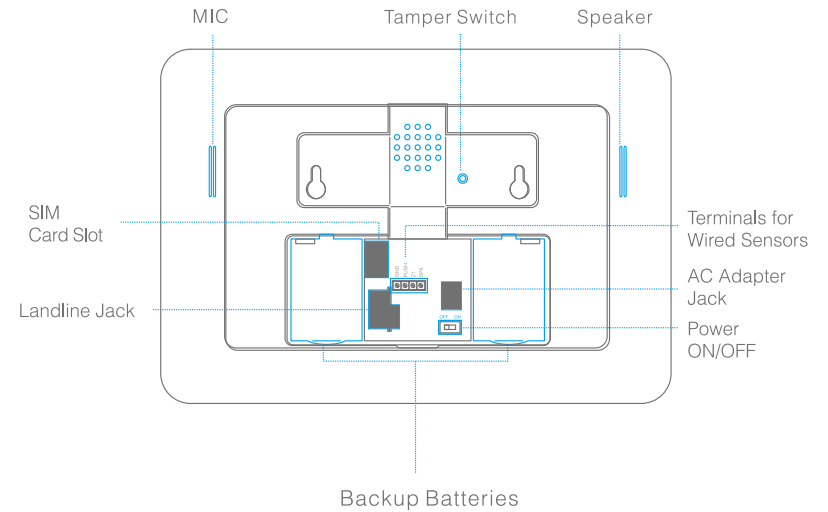

Preparation before Use

Power on

- ① Plug the output connector of AC adapter into the adapter Jack of control panel.
- ② Plug the AC adapter into a wall outlet.

Note:

In daily use, it is recommended to use external power supply. The built-in rechargeable battery should be used only in the case of AC power failure.

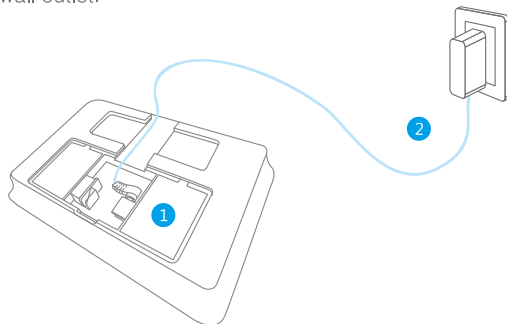

Connect PSTN Land Line

SAS-ALARM300 is a PSTN & GSM dual networks alarm system, If there is an alarm, it will auto dial pre-stored phone numbers through landline, or dial through GSM network when landline is unavailable.

- ① Connect the smaller connector of provided telephone cable to the PSTN land line interface at the back side of the panel.
- ② Connect the other end of the telephone cable to the signal output provided by PSTN land line operator.

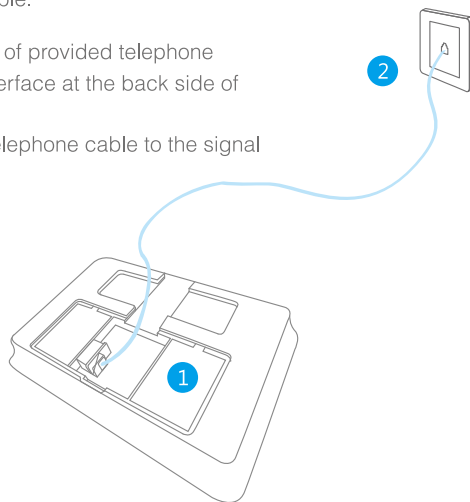

Insert a SIM Card

This step can be ignored if GSM function is not applied.

Insert a SIM card into the card slot according to the mark and lock it.

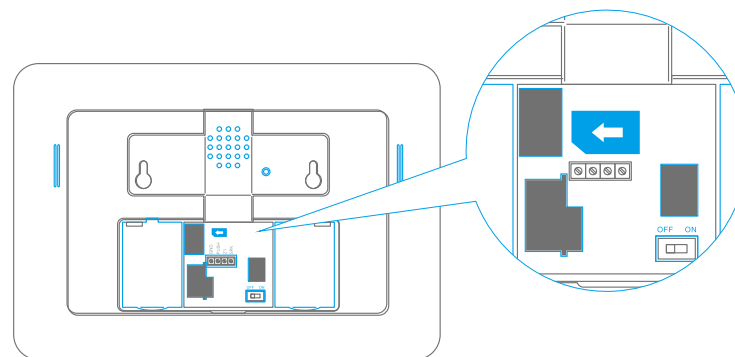

Note:

A GSM SIM card with normal functions (calling, answering, SMS and caller display) is required. If use App to control the alarm system through GPRS network, it is recommended to activate a GPRS plan to save expense. Insert the SIM card only after the control panel is switched off. Then, switch on the control panel so as to search signals. If no SIM card is inserted, the control panel can only send alarm notification by calls through land line and users cannot remote control the control panel through App. However, other functions are not affected.

Control Panel Operation

Alarm Control

Arm (Away Arm)

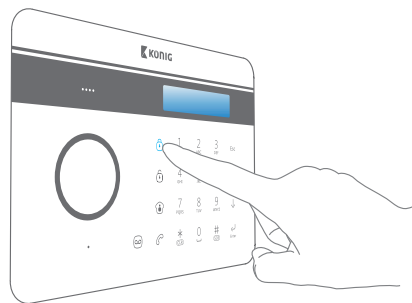

Press the [Arm ] button on the control panel, the system enters Arm state when one beep is heard and the arm LED Indicator lights on.

Note:

If Entry/Exit Delay is activated, all zones except the 24-hour zone will enter arm state after the set delay time.

Home Mode (Part Arm)



Press the [Home Mode ] button on the control panel, the system enters home mode when one beep is heard and the home mode LED Indicator lights on. All the normal sensors are armed except the home mode sensors which are disarmed, so that users can move freely at home.

Disarm

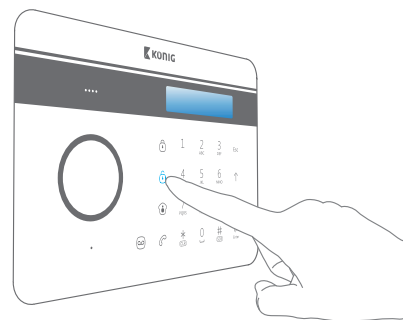

Input user code or admin code first, then press the [Disarm ] button, the system enters disarm state when one beep is heard and the disarm LED Indicator lights on.

Emergency Call

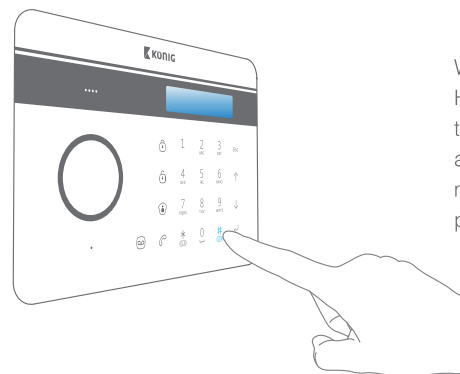

When the LCD display is activated, Hold the [] button for 3 seconds the system goes into emergent alarming state with siren hooting, meanwhile the panel will auto dial pre-stored alarm phone numbers.

Access Control System



The control panel has a RFID reader for unlocking the electronic door lock by disarming the system. Just place the RFID tag close to the RFID reader, the green LED indicator flashes once.

The system is disarmed and the electronic door lock is opened (If connected).

Make Phone Calls

The control panel has a built-in communication module. If the PSTN land line is connected or SIM card is connected properly, and the credit is enough, you can use the panel to make calls.

(System will auto dial through land line first, or dial through GSM network when land line is unavailable).

When the control panel is in disarm or home mode state, press [Call] button, input the phone number and press [Call] button again, the line will get through.



If you input wrong numbers, press [Esc] button and input again. Press [Esc] button to cancel dialing or press [Call] button to end a conversation.

Note: If control panel is connected with extension line, 0# or 9# need to be added in front of the phone number when making phone calls. If the land line is unavailable, system will switch to GSM network, user can make phone calls by inputting phone number directly without 0# or 9#.

Voice Memo

Press the [Record Voice Memo] button for 3 seconds to record 10 seconds voice message. The Play Voice Memo circle will be flashing to remind you. Users can touch the center of circle to listen to the voice memo. The LED indicator blacks out when the voice memo has been played. Replay by touching it again. The latest voice memo will cover the former message.

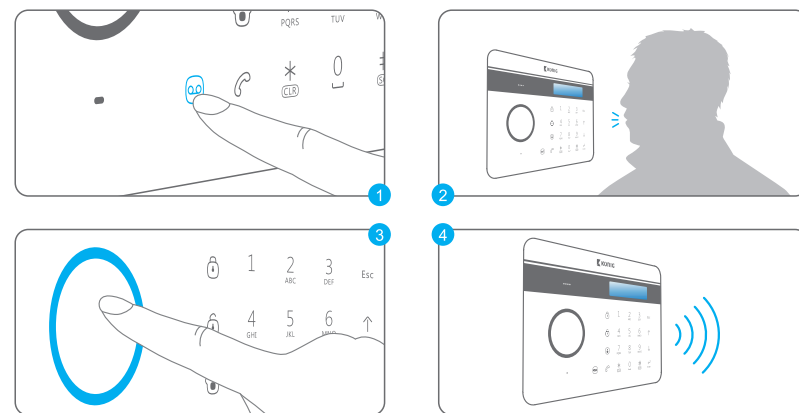

Function Setting

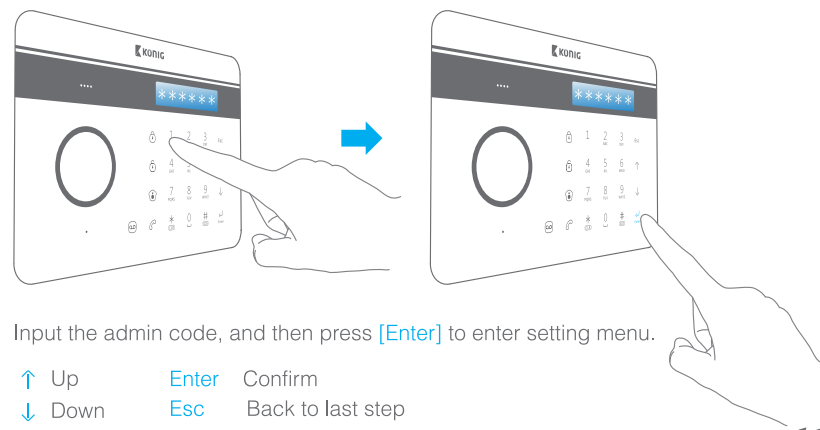

Input the admin code, and then press [Enter] to enter setting menu.

- ↑ Up
- ↓ Down
- Enter Confirm
- Esc Back to last step

Security Alarm Function

Test Accessories

Our accessories can work only with our control panels, can not work with other brands.

Remote Control

SAS-ASRC300 remote control is dainty and delicate, easy to carry. It can be attached to your key ring, or just put into your pockets or purses. When you are about to exit or entry the house, you can use it to arm or disarm the system. In case of emergency, just press the [SOS] button, the alarm will be activated immediately.

Appearance

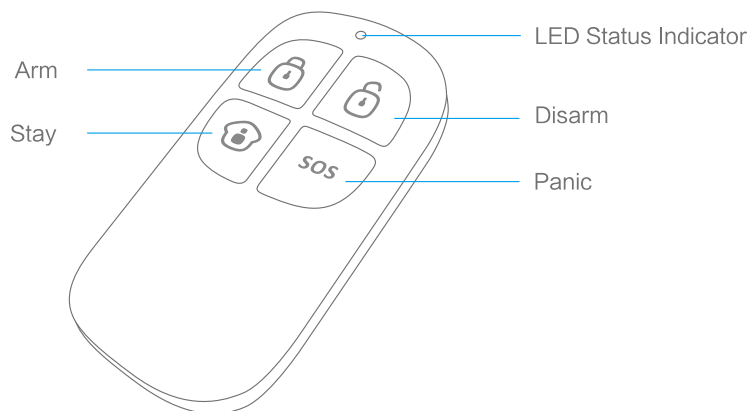

Arm





Press the [Arm ] button, the system enters arm state when one beep is heard and the arm LED on the control panel is on.

Note: If Exit Delay is activated, all zones except the 24-hour zone will enter arm state after the set delay time.

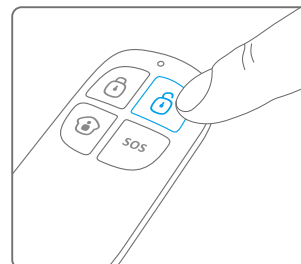
Disarm



Press the [Disarm ] button on the remote control, the system enters disarm state when two beeps are heard and the disarm LED on the control panel is on.

When alarm is activated, the siren will hoot. Press the [Disarm ] button, the system is disarmed. But the LED indicator of triggered zone keeps flashing for further checking. Press [Disarm ] button again, the alarming zone indicator goes out.

Home Arm (Part Arm)



Press [Stay ] button on the remote control, the system enters home mode when one beep is heard and the home mode LED is on. All the normal sensors are armed except the home mode sensors which are disarmed, so that users can move freely at home.

Mute Operation

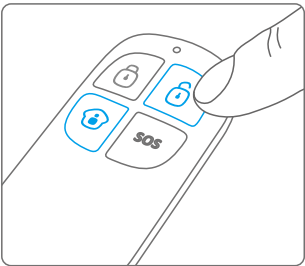

When arm or disarm the system, the siren will beep accordingly.
If siren beep is not needed, please operate as follows:
Press [Stay] button on the remote control for 1 second, then press [Arm] or [Disarm] button. The siren is armed or disarmed in mute without disturbing other people.

Note: If wireless strobe sirens are used, they will not sound either.

SOS

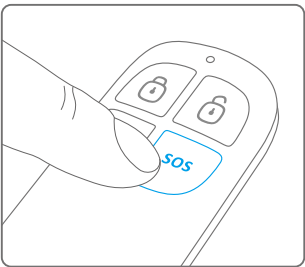

Whenever you press the [SOS] button on the remote control, the system will alarm immediately.

Door/Window Contact

The SAS-ASDW300 door/window contact can be installed on doors, windows, and any other objects that can open and close. The sensor transmits signals to the control panel when a magnet mounted near the sensor is moved away. External input for wired accessory is available at the N/C interface. The tamper protection ensures that sabotage attempts to move the contact will result in an alarm activation.

Appearance

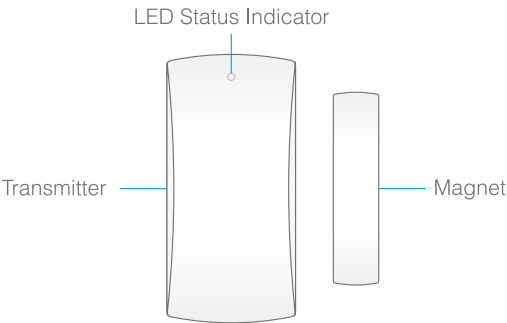

LED Indication

LED	Meaning
Blinks once	Door/Window contact is triggered
Blinks once per 3 seconds	Low battery indication, LCD shows: Sensor 1-50(Sensor Name) Low Battery. Please change the batteries immediately

PCB Layout

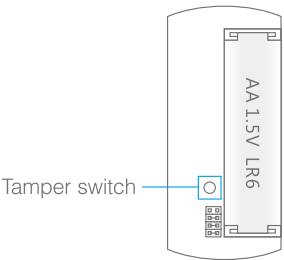

Test

1. Press the back cover and slide down to remove the back cover.
2. Remove the insulating strip. The contact works immediately.
3. Press the [Arm Ⓜ] button on the remote control. The system switches to the arm status. Separate the transmitter and magnet. The LED is on and the panel alarms. It indicates that the sensor works properly.

Note: There are triangle marks on the side of the transmitter and magnet. Make sure the triangle marks face each other and within the range of 1 cm.

Installation

Mount the transmitter on the frame and the magnet on the door or window. Make sure the magnet is on the right side of the transmitter. Secure the transmitter and magnet on the desired locations with double-sided tapes or screws.

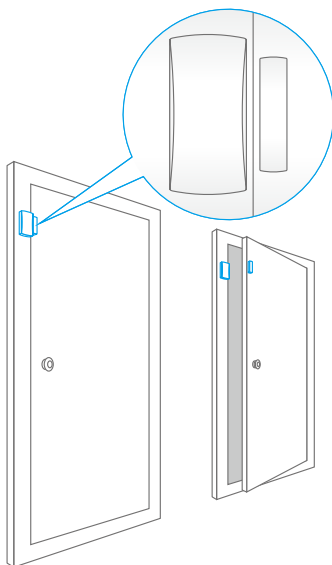

Note: Make sure the transmitter and magnet works properly on the desired locations. If a metal door is installed, place spacers under the transmitter and magnet. Do not apply the contact to a rolling shutter. Purchase dedicated contacts for rolling shutters when necessary.

Pet-Immune PIR Motion Detector

The SAS-ASMS310 detector adopts digital dual-core fuzzy logic control processing technology and intelligent analysis algorithm, effective resolution of interfering signal and human movement signal, preventing false alarm. It features automatic temperature compensation and resistance to flow technology, adapting to environmental and temperature change. It can detect human movement within the 8-meter cone space, suitable for halls, hallways, etc. The detector features pet immunity for small animals up to 25kgs.

Appearance

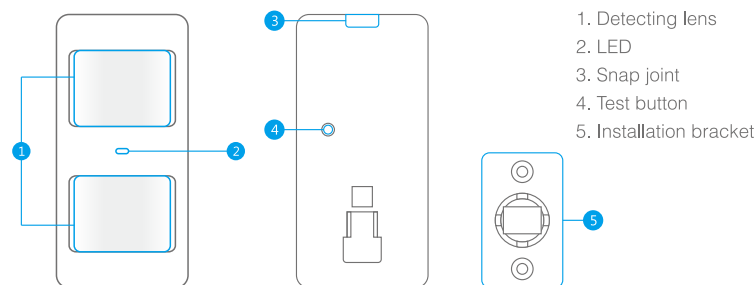

LED Indication

Blinks continuously: Under self-testing state.

Blinks once: Intruder is detected.

Blinks twice: 3 minutes testing is finished, enters power saving mode.

Blinks once per 3 seconds: Low battery indication, LCD shows: Sensor 1-50(Sensor Name) Low Battery, please change the batteries immediately.

PCB Layout

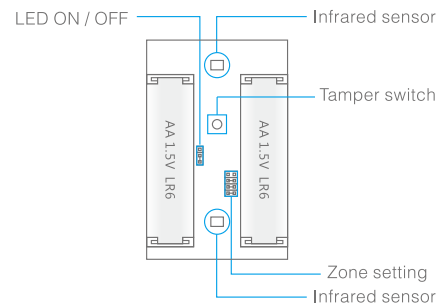

Note: If the detector is disassembled, system will sound immediately, and LCD shows "Sensor 1-50(Sensor Name) Sensor Tamper".

Working Mode

Testing mode

After self-testing, the detector enters testing mode, and detects once every 10 seconds. After 3 minutes, the LED blinks twice, and the detector enters power saving mode.

Hold the test button and load the battery, then release the test button, the detector stands in testing mode, it keeps detecting once every 10 seconds. Exits this status by reloading the battery without holding the test button.

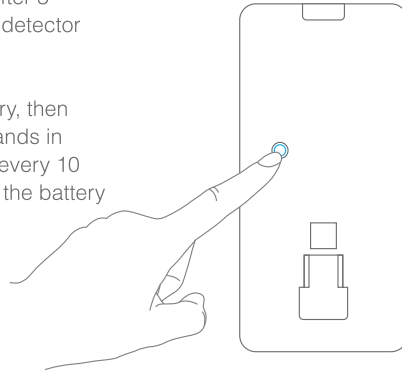

Power saving mode

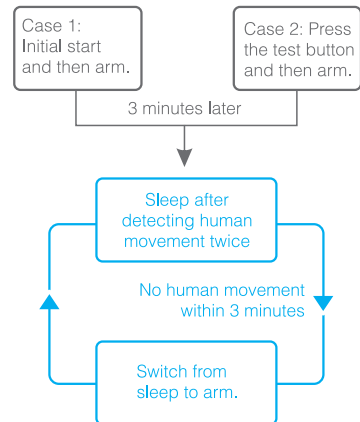

The product features power-saving design. If the detector detects human movement twice in 3 minutes, it will switch to the sleeping state to save power. At this time, the LED will not blink and no alarm. After no movement within the next 3 minutes, the detector switches back to the working state automatically.

Note: After the detector is in the sleeping state, ensure no human movement within 3 minutes; otherwise, the detector remains sleeping. In the sleeping state, it is recommended that you leave the room after arming the system. Ensure no human movement in 3 minutes. Then, go into the room, the system alarms immediately.

Test

1. Remove the insulating strip

Press the buckle to open the back cover. Remove the insulating strip. After 30-second self-testing, the detector switches to the testing mode.

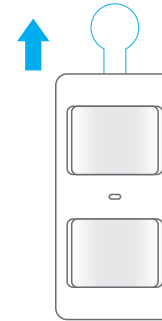

2. Arm

Press the [Arm] button on the remote control. The system is in the armed state.



3. Trigger the alarm

Keep pressing the test button at the back until the siren sounds.

Note: The testing mode sustains for 3 minutes. Then, the LED blinks twice, indicating the detector is in the power saving mode.

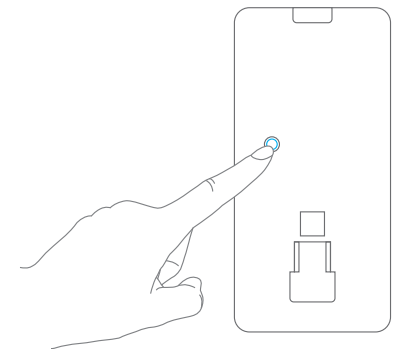

Installation

1. Choose installation place

It is recommended to mount it at the height of 2m from the ground. (For installation notices, please see page 22-23)

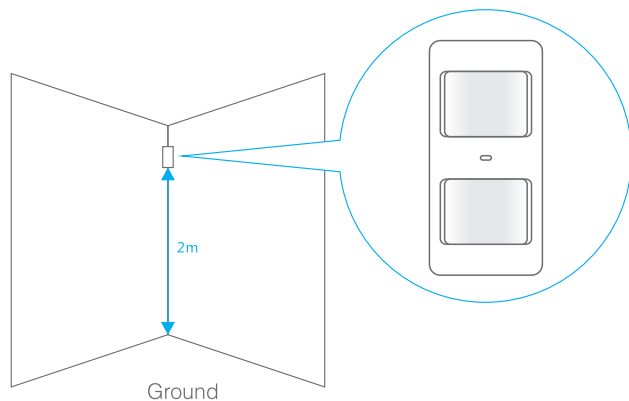

2. Fix the detector

Fix the installation bracket on the wall with screws, and then fit the groove at the back of the detector on the bracket.

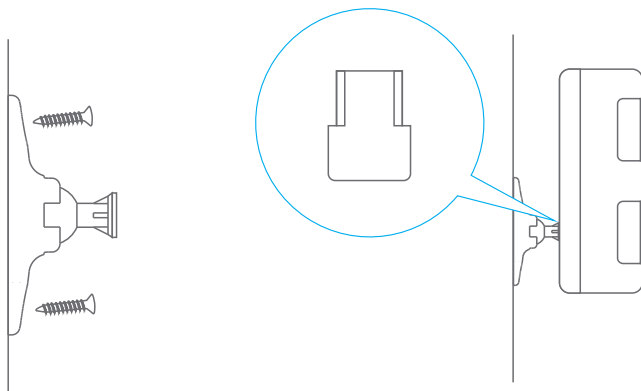

3. Testing

Press the test button on the back of the detector, walk in the detection scope and watch the LED indication to make sure the detector is working.

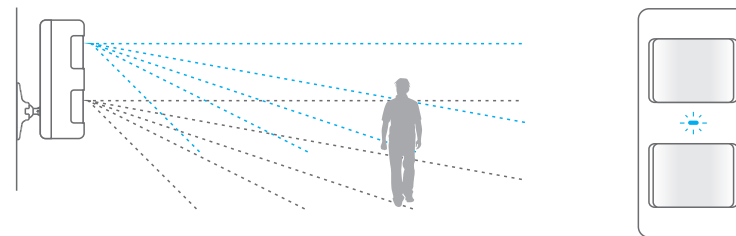

4. Adjust the bracket angle

Adjust the bracket angle to achieve the best detection effect.

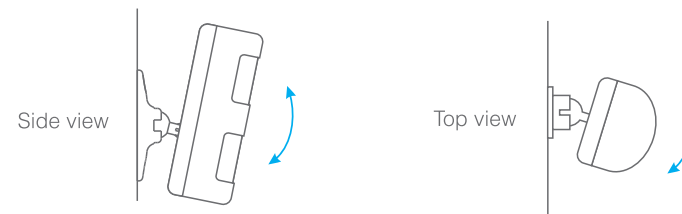

Note: If pet-immune function is used, please do not adjust the angle up or down, but keep it parallel with the wall.

5. Detection Scope

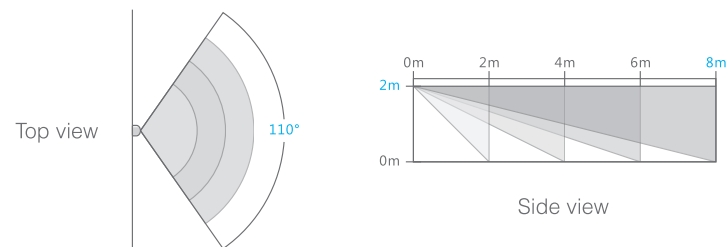

Installation Notices

Pay attention to the following during installation:

1. Mount the detector to a location close to the entry or exit

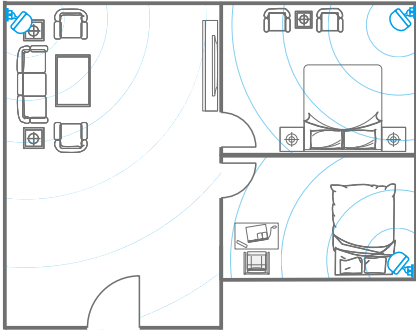

The detector aims at preventing intrusion. Detecting human movement at the entry or exit is critical for security.

2. Mount the detector in a proper angle

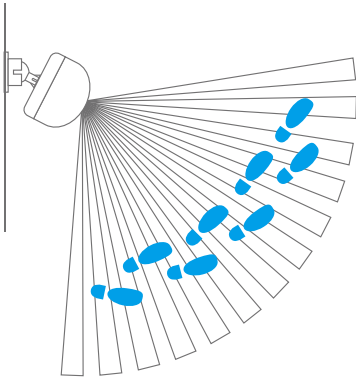

The installation angle affects sensitivity directly. The sensitivity is optimal when the walk direction is vertical to the infrared direction. Choose the best location and angle according to the actual situation and detection scope diagram.

3. Avoid facing to glass windows or doors

Strong light interferes with detection sensitivity. In addition, complicated situations, such as traffic flow, stream of people, also should be avoided.

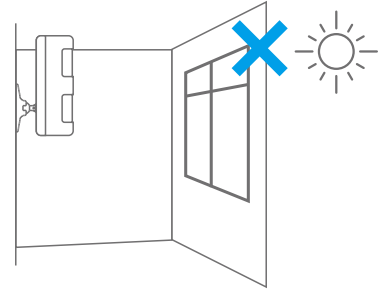

4. Avoid facing or positioning close to heat

Avoid facing or positioning close to heat sources such as heat extraction units, heaters, air conditioner, microwave oven, refrigerator, which may cause false triggering.

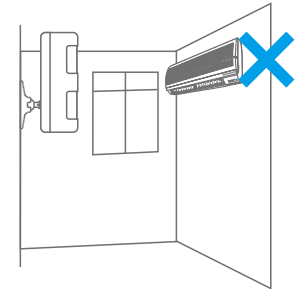

5. Avoid facing to swinging objects

Swinging objects may also trigger false triggering. Besides, if there are two detectors covering the same scope, adjust the locations to prevent cross-interference.

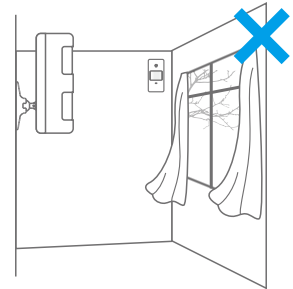

LCD Display Contents

System Status	Display content
Stand-by	Line Disconnect
	AC Power Failure
	Host Low Battery
	GPRS Connected
	Sensor 1-50(Sensor Name) Low Battery
	NO SIM CARD
	GPRS Connecting
	GPRS Disconnected
Arm or Disarm	System Arm
	System Disarm
	System Home Arm
	Remote Arm
	Remote Disarm
	Remote Home Arm
	RFID 1-50(RFID Name) Disarm
	GPRS Arm
	GPRS Disarm
	GPRS Home Arm
	SMS Arm
	SMS Disarm

Arm or Disarm	SMS Disarm
	SMS Home Arm
Alarm	Alarm SOS
	Alarm Linecut
	Alarm Panel Tamper
	Alarm Wired Sensor
	Sensor 1-50(Sensor Name) Sensor Tamper
	Alarm Sensor 1-50(Sensor Name)
	Alarm Sensor 1-50(Sensor Name)

LCD Display Menu

When LCD is activated, input the admin code, and then press [Enter] to enter setting menu.

Main Menu	Sub Menu 1	Sub Menu 2	Sub Menu 3
Phone Numbers	Add Phone Number	Alarm Number1-6	-
		CMS Number1-2	-
	Del Phone Number	Alarm Number1-6	-
		CMS Number1-2	-
Accessories	Remote & Keypad	Add	-
		Delete	ALL Remote (01-10)
	RFID Tag	Add	-
		Delete	ALL RFID (01-50)
		Edit Name	RFID (01-50)
	Wireless Sensors	Add	-
		Delete	ALL Sensor (01-50)
		Edit	Sensor (01-50) Edit Sensor Type (Normal Sensor, 24 Hour Sensor, Delay Sensor, Home Sensor) Edit Sensor Name
	Test Mode	-	-

System Settings	Date And Time	Date	-
		Date Format	-
		Time	-
	Entry Exit Delay	Entry Delay <000S>	-
		Exit Delay <000S>	-
	Backlight Time <20S>		-
	Auto Arm/ Disarm	Auto Arm Time <00:00:00>	-
		Auto Disarm Time <00:00:00>	-
	Edit Welcome		-
	Linecut Alarm	On Off	-
	Keypad Tones	On Off	-
	Access Code	Admin Code	Input 6 Digits <Default Code 123456>
		User Code	Input 4 Digits <Default Code 1234>
		Duress Code	Input 4 Digits <Default Code 1111>

System Settings	Ringing Times	-	-
	Alarm Message	Record	-
	Siren Setup	Wired Siren	Siren On/Off <On/Off>
			Arm/Disarm Tone <On/Off>
		Wireless Siren	Siren On/Off <On/Off>
			Arm/Disarm Tone <On/Off>
		Built-in Siren	Siren On/Off <Off/Low/High>
			Arm/Disarm Tone <On/Off>
		Siren Alert Time <300S>	-
	User ID<1234>	Input 4 Digits	-
	Arm Upload	On Off	-
	Disarm Upload	On Off	-
	Reset	-	-
History	-	-	-

Settings

When LCD is activated, input the admin code, and then press [Enter] to enter setting menu.

1. Alarm Phone Number Setup

User can set 6 user phone numbers and 2 CMS phone numbers. When connecting to CMS, system will dial CMS phone number to upload Contact ID reports while alarming and then dial 6 user phone numbers in sequence one by one. System will dial all the user phone numbers in 3 cycles until the phone is answered together with any operation on phone buttons.

Add Alarm Phone Number

- ① Log on the menu, choose "Phone Numbers", press [Enter].
- ② Press [↓] or [↑], choose "Add Phone Number", press [Enter].
- ③ Press [↓] or [↑], choose "Alarm Number1~6", press [Enter].
- ④ Input alarm phone numbers in order, press [Enter]. If group extended telephone number is used, 0# or 9# need to be added in front of the phone number.

Note: If user wants to check or edit the stored phone number, enter "Alarm Number1~6" to check and edit.

Delete Alarm Phone Number

- ① Log on the menu, choose "Phone Numbers", press [Enter].
- ② Press [↓] or [↑], choose "Delete Phone Number", press [Enter].
- ③ Press [↓] or [↑], choose "Alarm Number1~6", press [Enter].
- ④ Delete the alarm phone numbers in order, press [Enter] again.

Note: If user wants to set CMS center phone number, please refer to "Connect to CMS Center".

2. Add/Delete/Edit Accessories

The control panel only receives signal from accessories after they are connected to the control panel.

Add/Delete Remote Controls or Wireless Keypads

Add

- ① Log on the menu, press [↓] or [↑], choose "Accessories", press [Enter].
- ② Press [↓] or [↑], choose "Remote & Keypad", press [Enter].
- ③ Press [↓] or [↑], choose "Add", press [Enter].
- ④ LCD display will show "Please connect", press any button from the remote control to enable signal transmitting to the control panel. When a beep is heard, LCD display will show "Remote (01-10)", connection succeeded.
When 2 beeps are heard, it means this accessory has connected with control panel before.

Note: When adding wireless keypad to control panel, please enter access code and then press "arm" or "disarm" button on the wireless keypad. When a "beep" is heard, the system is connected to the panel successfully.

Delete

If user wants to delete the added remote controls or wireless keypads, please choose "Delete" in step ③ as above and press [Enter]. Then choose to delete all or specific remote controls or wireless keypads, press [Enter] again.

Add/Delete/Edit RFID Tags

Add

- ① Log on the menu, press [↓] or [↑], choose "Accessories", press [Enter].
- ② Press [↓] or [↑], choose "RFID Tag", press [Enter].
- ③ Press [↓] or [↑], choose "Add", press [Enter].
- ④ LCD display will show "Please connect", place the RFID tag close to the RFID reader on the control panel. When a beep is heard, LCD display will show "RFID (01-50)", connection succeeded. When 2 beeps are heard, it means this accessory has connected with control panel before.

Delete

If user wants to delete the added RFID cards or tags, please choose "Delete" in step ③ as above and press [Enter]. Then choose to delete all or specific RFID cards or tags, press [Enter] again.

Edit

If user wants to rename the added RFID cards or tags, please choose "Edit Name" in step ③ as above and press [Enter], then input the name.

Note: press the [*] button of the control panel to clean when wrong input.
Press the [ESC] to exit.

Add/Delete/Edit Wireless Sensors

Add

- ① Log on the menu, press [↓] or [↑], choose "Accessories", press [Enter].
- ② Press [↓] or [↑], choose "Wireless Sensors", press [Enter].
- ③ Press [↓] or [↑], choose "Add", press [Enter].
- ④ LCD display will show "Please connect", trigger the detector once to make it send wireless signal to the control panel. When a beep is heard, LCD display will show "Sensor (01-50)", connection succeeded. When 2 beeps are heard, it means this accessory has connected with control panel before.

Delete

If user wants to delete the added sensors, please choose "Delete" in step ③ as above and press [Enter]. Then choose to delete all or specific wireless sensors, press [Enter] again.

Edit

Edit Type of Sensors

- ① Log on the menu, press [↓] or [↑], choose "Accessories", press [Enter].
- ② Press [↓] or [↑], choose "Wireless Sensors", press [Enter].
- ③ Press [↓] or [↑], choose "Edit", press [Enter].
- ④ Press [↓] or [↑], choose "Sensor 01-50", press [Enter].
- ⑤ Press [↓] or [↑], choose "Edit Sensor Type", press [Enter].
- ⑥ Press [↓] or [↑], choose one type of "Normal Sensor/ 24 Hour Sensor/ Delay Sensor/ Home Sensor", press [Enter].

Normal Sensor: In arm mode, when normal sensors are triggered, system will alarm. In disarm mode, when normal sensors are triggered, system will not alarm.

24 Hour Sensor: Under any circumstances, when 24 hour sensors are triggered, system will alarm at once.

Delay Sensor: In arm mode, when delay sensors are triggered, system will alarm after the set time if the entry delay time was set before. (For "Entry Delay", please refer to page 33).

Home Sensor: In home mode, only normal sensors will be triggered for alarming while home sensors will not be triggered. This will allow user to move freely at home.

Names of Sensors

If user wants to rename the sensors, please choose "Edit Sensor Name" in step 5 and press [Enter]. Then input the sensor name.

Note: press the [*] button of the control panel to clean when input wrong.
Press the [ESC] to exit.

Test Mode

Test if the sensors are connected successfully to the control panel.

- ① Log on the menu, press [↓] or [↑], choose "Accessories", press [Enter].
- ② Press [↓] or [↑], choose "Test Mode", press [Enter]. LCD display will show "Yes?", press [Enter] again to start testing mode for 10 minutes.
- ③ Please trigger coded sensors in order, the sensors will transmit signals to control panel. When 3 beeps are heard, LCD display will collect the triggering time of the sensors. Then you can count the connected sensors based on the numbers displayed on the LCD screen. Exit by pressing [Esc] button.

3. System Settings

Date and Time

Date

- ① Log on the menu, press [↓] or [↑], choose "System Settings", press [Enter].
- ② Press [↓] or [↑], choose "Date and Time", press [Enter].
- ③ Press [↓] or [↑], choose "Date", press [Enter].
- ④ Input date, press [Enter].

Date Format

- ① Log on the menu, press [↓] or [↑], choose "System Settings", press [Enter].
- ② Press [↓] or [↑], choose "Date and Time", press [Enter].
- ③ Press [↓] or [↑], choose "Date Format", press [Enter].
- ④ Press [↓] or [↑], choose format, press [Enter].

Time

The default time is set on 24 hours standard.

- ① Log on the menu, press [↓] or [↑], choose "System Settings", press [Enter].
- ② Press [↓] or [↑], choose "Date and Time", press [Enter].
- ③ Press [↓] or [↑], choose "Time", press [Enter].
- ④ Input current time, press [Enter].

Entry and Exit Delay

If user is not used to taking along with the remote control, entry and exit delay could be set.

When entry and exit delay is set, user could exit the house in set time period, then system will be armed automatically; when user is back without disarming the system, entry delay will allow time for user to disarm the system. Otherwise, the system will take this as an intrusion and send out alarming alert.

Entry Delay

Entry delay is set to leave time for user to disarm the system when delay sensors are triggered.

- ① Log on the menu, press [↓] or [↑], choose "System Settings", press [Enter].
- ② Press [↓] or [↑], choose "Entry Exit Delay", press [Enter].
- ③ Press [↓] or [↑], choose "Entry Delay", press [Enter].
- ④ Input time for entry delay; press [Enter] for confirmation.

Entry delay time is calculated on seconds; default is 0 second (off); setup range is 0-999 seconds.

Note: The zone setting of delay sensor, please refer to page 31.

Exit Delay

Exit delay is set to leave time for user to exit before the system is armed.

- ① Log on the menu, press [↓] or [↑], choose "System Settings", press [Enter].
- ② Press [↓] or [↑], choose "Entry Exit Delay", press [Enter].
- ③ Press [↓] or [↑], choose "Exit Delay", press [Enter].
- ④ Input time for exit delay; press [Enter] for confirmation.
Exit delay time is calculated on seconds; default is 0 second (off); setup range is 0-999 seconds.

Note: Once delay time is set, when arm the system, one beep will be heard every second to remind the user to leave, the reminding rhythm will speed up in the last 15 seconds.

Backlight Time

User can set standby time of the backlight on the blue LCD display accordingly.

- ① Log on the menu, press [↓] or [↑], choose "System Settings", press [Enter].
- ② Press [↓] or [↑], choose "Backlight Time", press [Enter].
- ③ Input time for backlight time; press [Enter].

Backlight time is calculated on seconds; default is 20 seconds; setup range is 01-99 seconds.

Timed Arm / Disarm

User can set timed arm and disarm according to daily schedule to avoid repeated operation.

Timed Arm

- ① Log on the menu, press [↓] or [↑], choose "System Settings", press [Enter].
- ② Press [↓] or [↑], choose "Auto Arm/Disarm", press [Enter].
- ③ Press [↓] or [↑], choose "Auto Arm Time", press [Enter].
- ④ Input exact time for arming; press [Enter].

Timed Disarm

- ① Log on the menu, press [↓] or [↑], choose "System Settings", press [Enter] for confirmation.
- ② Press [↓] or [↑], choose "Auto Arm/Disarm", press [Enter].
- ③ Press [↓] or [↑], choose "Auto Disarm Time", press [Enter].
- ④ Input exact time for disarming; press [Enter].

Edit Greeting Message

When greeting message is set; turn on the alarm system or activate the touch keyboard; the greeting message will be shown on LCD display.

- ① Log on the menu, press [↓] or [↑], choose "System Settings", press [Enter].
- ② Press [↓] or [↑], choose "Edit Welcome", press [Enter] to define the greeting message.

[*] means to delete, [#] means to space, [↓] means to move backward, [↑] means to move forward.

Line Cut Alarm

When linecut alarm function is on, the control panel will alarm once the PSTN land line is cut or pulled out even if the built-in siren was set to mute..

Turn On/Off Linecut Alarm

- ① Log on the menu, press [↓] or [↑], choose "System Settings", press [Enter].
- ② Press [↓] or [↑], choose "Linecut Alarm", press [Enter].
- ③ Press [↓] or [↑], choose "On" or "Off", press [Enter].

"On" is to turn on the linecut alarm; "Off" is to turn off the linecut alarm.
Default setting is "On", the linecut alarm is on.

Keypad Tone

User can turn on/off keypad tone accordingly.

Turn On/Off Keypad Tone

- ① Log on the menu, press [↓] or [↑], choose "System Settings", press [Enter].
- ② Press [↓] or [↑], choose "Keypad Tone", press [Enter].
- ③ Press [↓] or [↑], choose "On" or "Off", press [Enter].

"On" is to turn on the keypad tone; "Off" is to turn off the keypad tone. Default setting is "On", keypad tone is on.

Access Code

All the alarm panels are with default user code, admin code and duress code. Please change all codes before using and keep your codes secret.

Admin Code

With admin code, user can arm and disarm, make system settings as well as reset codes etc.

- ① Log on the menu, press [↓] or [↑], choose "System Settings", press [Enter].
- ② Press [↓] or [↑], choose "Access Code", press [Enter].
- ③ Press [↓] or [↑], choose "Admin Code", press [Enter].
- ④ LCD display will show "Input 6 Digits", then input 6 digits for code, press [Enter]. (Default Admin Code: 123456)
- ⑤ Input the new admin code, press [Enter].

User Code

With user code, user can set arm, home mode and disarm the alarm system.

- ① Log on the menu, press [↓] or [↑], choose "System Settings", press [Enter].
- ② Press [↓] or [↑], choose "Access Code", press [Enter].
- ③ Press [↓] or [↑], choose "User Code", press [Enter].
- ④ LCD display will show "Input 4 Digits", then input 4 digits for code, press [Enter]. (Default User Code: 1234)
- ⑤ Input the new user code, press [Enter].

Duress Code

In case of emergency, when user is violently requested to disarm the system, it's recommended to use the duress code to disarm the alarm system. The panel will silently dial alarm telephone numbers stored.

- ① Log on the menu, press [↓] or [↑], choose "System Settings", press [Enter].
- ② Press [↓] or [↑], choose "Access Code", press [Enter].
- ③ Press [↓] or [↑], choose "Duress Code", press [Enter].
- ④ LCD display will show "Input 4 Digits", then input 4 digits for code, press [Enter]. (Default Duress Code: 1111)
- ⑤ Input the new duress code, press [Enter].

Ringing Times for Remote Phone Control

After the set ringing times, user can make system settings from remote calling, such as arming/disarming the system.

- ① Log on the menu, press [↓] or [↑], choose "System Settings", press [Enter].
- ② Press [↓] or [↑], choose "Ringing Times", press [Enter].
- ③ Input 5~9 for ringing times, press [Enter].
Default setting is 5 times.

Alarm Message

User can leave a 10-second voice message when control panel makes call to user's stored phone number, voice recording will be repeatedly played to notify the intrusion.

Record Alarm Message

- ① Log on the menu, press [↓] or [↑], choose "System Settings", press [Enter].
- ② Press [↓] or [↑], choose "Alarm Message", press [Enter].
- ③ Press [↓] or [↑], choose "Record", press [Enter].
- ④ LCD display will show "Record 10s Voice" to remind you of the 10 seconds voice recording, press [Enter].
- ⑤ Start voice recording for 10s until the system stops automatically, or press [Enter] to stop recording.

Siren Setup

Users can turn on/off wired siren, wireless siren, built-in siren as arm/disarm beep and set siren ringing time.

Wired Siren

Wired siren is connected to the control panel by wire.

Turn On/Off Wired Siren

- ① Log on the menu, press [↓] or [↑], choose "System Settings", press [Enter].
- ② Press [↓] or [↑], choose "Siren Setup", press [Enter].
- ③ Press [↓] or [↑], choose "Wired Siren", press [Enter].
- ④ Press [↓] or [↑], choose "Siren On/Off", press [Enter].
- ⑤ Press [↓] or [↑], choose "On" or "Off", press [Enter]
"On" is to turn on the wired siren; "Off" is to turn off the wired siren.
Default setting is "On"; the wired siren is on.

Turn On/Off Arm/Disarm Beep for Wired Siren

- ① Log on the menu, press [↓] or [↑], choose "System Settings", press [Enter].
- ② Press [↓] or [↑], choose "Siren Setup", press [Enter].
- ③ Press [↓] or [↑], choose "Wired Siren", press [Enter].
- ④ Press [↓] or [↑], choose "Arm/Disarm Beep", press [Enter].
- ⑤ Press [↓] or [↑], choose "On" or "Off", press [Enter]

"On" is to turn on arm/disarm beep for wired siren; "Off" is to turn off arm/disarm beep for wired siren.

Default setting is "On"; arm/disarm beep is on.

Wireless Siren

Wireless siren is connected to control panel through wireless connection.

Turn On/Off Wireless Siren

- ① Log on the menu, press [↓] or [↑], choose "System Settings", press [Enter].
- ② Press [↓] or [↑], choose "Siren Setup", press [Enter].
- ③ Press [↓] or [↑], choose "Wireless Siren", press [Enter].
- ④ Press [↓] or [↑], choose "Siren On/Off", press [Enter].
- ⑤ Press [↓] or [↑], choose "On" or "Off", press [Enter]

"On" is to turn on the wireless siren; "Off" is to turn off the wireless siren.

Default setting is "On"; the wireless siren is on.

Turn On/Off Arm/Disarm Beep for Wireless Siren

- ① Log on the menu, press [↓] or [↑], choose "System Settings", press [Enter].
- ② Press [↓] or [↑], choose "Siren Setup", press [Enter].
- ③ Press [↓] or [↑], choose "Wireless Siren", press [Enter].
- ④ Press [↓] or [↑], choose "Arm/Disarm Beep", press [Enter].
- ⑤ Press [↓] or [↑], choose "On" or "Off", press [Enter]

"On" is to turn on arm/disarm beep for wireless siren; "Off" is to turn off arm/disarm beep for wireless siren.

Default setting is "On"; arm/disarm beep is on.

Built-in Siren

Built-in siren is the siren inside the control panel.

Turn On/Off Built-in Siren

- ① Log on the menu, press [↓] or [↑], choose "System Settings", press [Enter].
- ② Press [↓] or [↑], choose "Siren Setup", press [Enter].
- ③ Press [↓] or [↑], choose "Built-in Siren", press [Enter].
- ④ Press [↓] or [↑], choose Siren Siren On/Off, press [Enter].
- ⑤ Press [↓] or [↑], choose Off/Low/High, press [Enter]

Choose "Low" or "High" to adjust the volume; "Off" is to turn off the built-in siren.

The default setting is "Low".

Turn On/Off Arm/Disarm Beep for Built-in Siren

- ① Log on the menu, press [↓] or [↑], choose "System Settings", press [Enter].
- ② Press [↓] or [↑], choose "Siren Setup", press [Enter].
- ③ Press [↓] or [↑], choose "Built-in Siren", press [Enter].
- ④ Press [↓] or [↑], choose "Arm/Disarm Beep", press [Enter].
- ⑤ Press [↓] or [↑], choose "On" or "Off", press [Enter]

"On" is to turn on arm/disarm beep for built-in siren; "Off" is to turn off arm/disarm beep for built-in siren. Default setting is "On"; arm/disarm beep is on.

Set Ringing Time for All Sirens

- ① Log on the menu, press [↓] or [↑], choose "System Settings", press [Enter].
- ② Press [↓] or [↑], choose "Siren Setup", press [Enter].
- ③ Press [↓] or [↑], choose "Siren Alert Time", press [Enter].
- ④ Input the ringing time, press [Enter].

Siren ringing time is calculated as seconds, default setting is 300 seconds. If 0 second is set, siren will not ring.

User ID for CMS

Please see details at Page 41: Connect to CMS

Upload Arm Report

Please see details at Page 42: Connect to CMS

Upload Disarm Report

Please see details at Page 42: Connect to CMS

Reset

- ① Log on the menu, press [↓] or [↑], choose "System Settings", press [Enter].
- ② Press [↓] or [↑], choose "Reset", press [Enter] to reset the system to default setting.

Note: All system settings will be restored to default setting. Reset will not delete the accessories that has already coded to the control panel.

If user forget the admin code and cannot setup the system, please contact local distributors.

4. Check Event Logs

Users can check the event logs freely. 150 event logs are traceable.

- ① Log on the menu, press [↓] or [↑], choose "History", press [Enter].
- ② Press [↓] or [↑], choose the event log you need to track, press [Enter].

Relevant event log time and alarm way will be shown.

Note: Hold [↓] or [↑] to skip the event logs.

Connect to Electronic Lock

Please ignore this if user is not intended to put this alarm as access control.

This alarm only sends on/off signal to electronic door lock, please refer to related electronic door lock manual for details.

Connect to CMS

Please ignore this step if users don't need to connect to CMS center.

When connected to CMS center, control panel will upload contact ID to CMS center automatically once intrusion is detected.

Add CMS Phone Number

When CMS center phone no. is stored, the control panel will auto dial to CMS center automatically when alarm.

- ① Log on the menu, choose "Phone Numbers", press [Enter].
- ② Press [↓] or [↑], choose "Add Phone Number", press [Enter].
- ③ Press [↓] or [↑], choose "CMS Number1" or "CMS Number2", press [Enter].
- ④ Input CMS phone no, press [Enter]. If group extension telephone no. is used to connect to the CMS center, please add 0# or 9# before the phone no. you plan to store.

Note: If user wants to check or edit the pre-stored phone no., enter "CMS Number1~2" to check or edit.

Delete CMS Phone Number

- ① Log on the menu, choose "Phone Numbers", press [Enter].
- ② Press [↓] or [↑], choose "Del Phone Number", press [Enter].
- ③ Press [↓] or [↑], choose in order "CMS Number1~2", press [Enter].
- ④ Delete stored CMS phone no., Press [Enter].

User ID

It is supplied by CMS center. After it is stored, CMS center can exactly know user's location according to the ID number.

- ① Log on the menu; press [↓] or [↑], choose "System Settings", press [Enter].
- ② Press [↓] or [↑], choose "User ID", press [Enter].
- ③ LCD display will show "Input 4 Digits", input 4 digits user ID, press [Enter].

Upload Arm/ Disarm Report to CMS Center

When this function is enabled, all arm/disarm reports will be uploaded automatically to CMS center, so that CMS center can know the status of the alarm system.

- ① After the User ID is set, press [↓] or [↑] to choose "Arm Upload" or "Disarm Upload", press [Enter].
- ② Press [↓] or [↑], Choose "On", press [Enter].
- ③ When choosing "Off" during setup②, press [Enter], arm/ disarm report will not be uploaded to CMS center.

Contact ID Reports

Event Code	Event	Event Code	Event
3401	Arm	1137	Control panel tamper alarm
1401	Disarm	1144	Sensor tamper alarm
1409	Disarm by RFID tag	1140	Normal zone alarm
1132	PIR detector alarm	1133	24H zone alarm
1131	Door contact alarm	1384	Sensor low battery
1100	Emergency call	1302	Control panel low battery
1120	Duress alarm	1301	Control panel AC failure
3456	Home mode (part arm)		

Remote Control Instruction

Users can operate the system by the control panel or remote control. Besides, using phone call, SMS or App on the phone can also operate the system remotely.

Phone remote control can be achieved through two ways:

Answering Alarm Phone Call to Start Remote Control

When an alarm occurs, the control panel will call the stored phone numbers. When answering the call, the user will hear the recorded voice message firstly. Then the voice prompt will guide user to control the system. The control panel will call these numbers for three rounds at most. when user pick up with key operation, control panel stops dialing. if not, control panel keeps dialing until three rounds are finished.

Remote Control by Calling Telephone Number

- ① Call the telephone number. The alarm system will guide you to input access code after getting through.
- ② Input access code (user code or admin code); Press # to confirm. The prompts indicate "Password correct".
- ③ Alarm system plays the voice prompts twice to explain the functions.
- ④ Users can choose the related instruction to make remote control operation. (See instruction table below). If there is no operation within 30 seconds, the system will hang up.

Remote Phone Control Instruction Table

Phone Buttons	Function	Explanation
Press [1]	Arm the system	Phone voice prompt "Arm Succeed"
Press [0]	Disarm the system	Phone voice prompt "Disarm Succeed"
Press [*]	Monitor on site	Press [*] to prolong monitor time
Press [9]	Turn on siren	Deter the intruders
Press [6]	Turn off siren	Siren stops ringing
Press [8]	Turn on relay	Available when relay is used
Press [5]	Turn off relay	
Press [#]	To exit Remote Phone Control	Or hang up the phone

Remote Control by Calling SIM Card Number

The system will enter monitor state directly when stored phone number called the SIM card number of control panel. User is able to continue the operation by input relative command. While any phone number can proceed this function without phone number is stored. So, it is command to store the phone number at the first beginning of the setting.

SMS Operation

You can control the system by sending SMS commands to the SIM card No. SMS is charged according to telecom operator.

Any phone number can send SMS to control the system by default, after you store alarm phone numbers to the control panel, system accepts only the commands from these numbers.

Disarm

This is to disarm the system. In disarmed status, the detectors (except those accessories in the 24-hour zone) will not trigger an alarm when detecting intrusion.

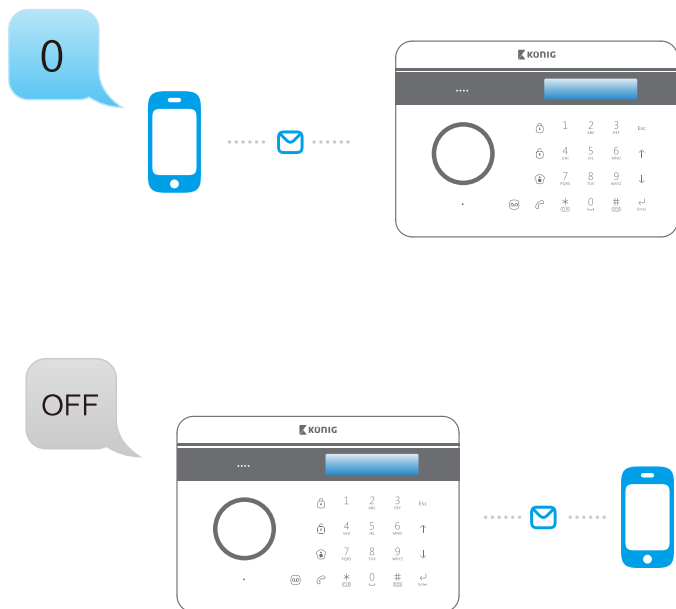

Arm (Away Arm)

This is to arm the system. In armed status, the system will trigger an alarm when detecting intrusion.

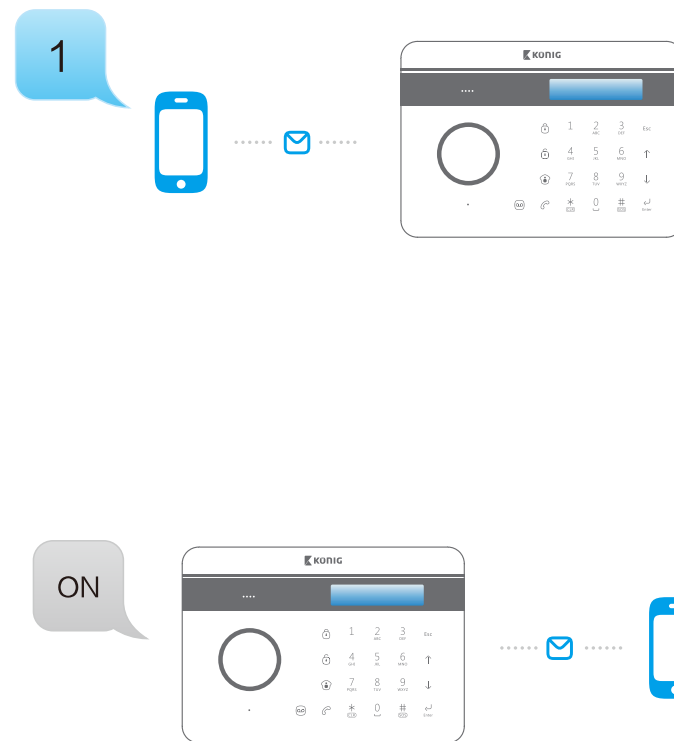

Home Mode (Part Arm)

In home mode, detectors setting to home mode zone are in disarmed status; the other detectors are still in armed status. That is, you can move freely in the home mode zone; however, the rest areas are still being protected.

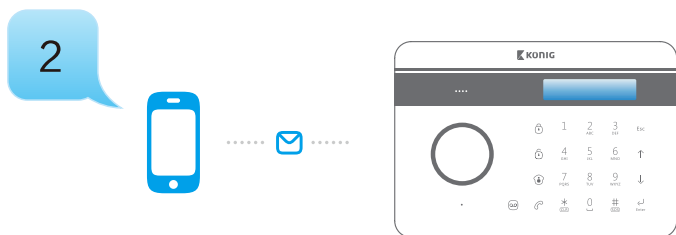

Monitor

This is to monitor the site remotely by call-back from the control panel. After the control panel receives the SMS, it calls your phone number. Then, you can answer the call and monitor (listen in) the site.

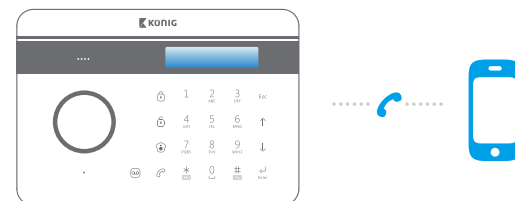
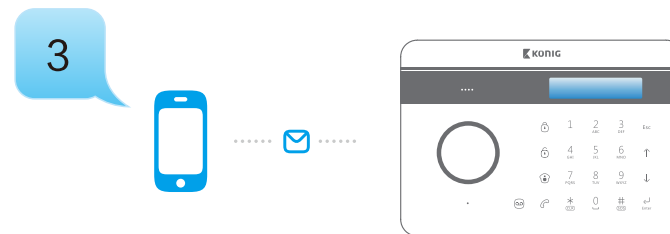

Recording Voice Memo

This is to record a 10-second voice memo by call-back from the control panel. After the control panel receives the SMS, it calls your phone number. Answer the phone and then you can start to record a 10-second voice memo. The control panel will hang up phone after 10 seconds.

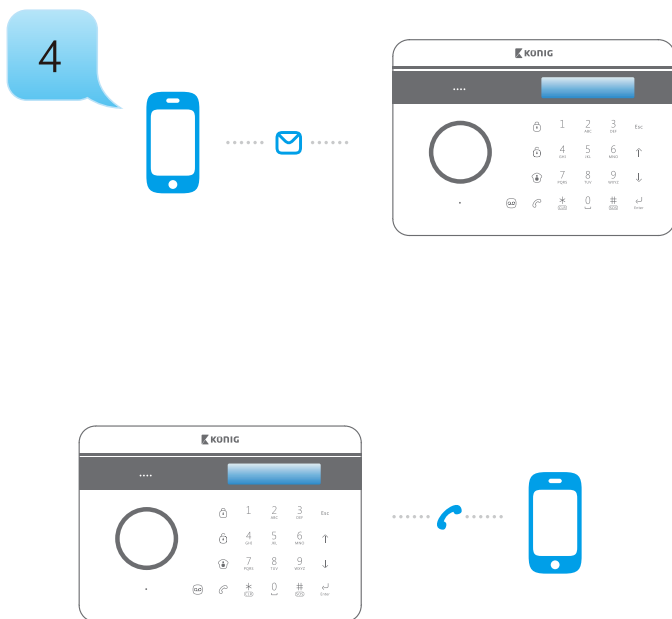

App Operation

This system can be controlled through SMS or GPRS interface on APP. If user choose SMS: for iPhone, the interface of sending SMS will display. For Android smart phones, SMS will be directly sent to the number of the control panel without interface redirection.

Download and Install APP

Search keywords "B11 alarm" in Apple Store or Google Play, downloads it for free.



Control through SMS

Any phone number can operate the system through APP by default, after you stored alarm phone numbers on the control panel, system accepts only the commands from these numbers.

1. Add accounts

Adding accounts enables you to add more accounts to control several SAS-ALARM300 alarm systems on one phone.

① Enter [Accounts]

Tap B11 APP, choose [SMS], and then enters account management interface.



② Add account

Tap [+], input the SIM card number of the control panel on [Mobile Number], and then tap [OK].

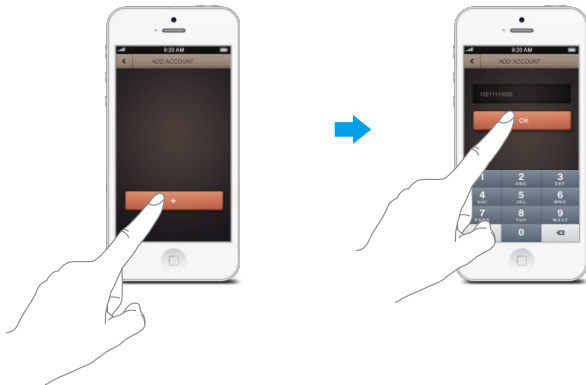

2. Operations on main menu

Tap the SIM card number of the control panel to enter the main menu, user can perform disarm, arm, home arm, monitor and leave voice memo.

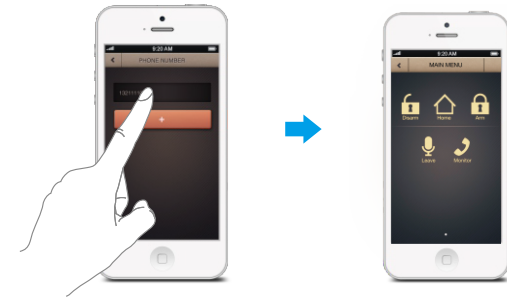

3. Delete accounts

iPhone: Tap [EDIT], choose the account number, tag [⊖] to confirm deletion.

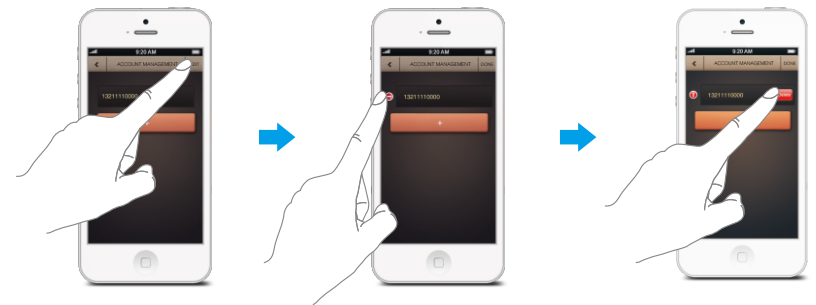

Android phone: Tap [EDIT], press and hold the account number until the dialog box appears, tap [OK] to confirm deletion.

Control through GPRS Data

APN Setting

Some SIM cards need to set APN to open GPRS function. If the GPRS function of the SIM card in the unit doesn't work out. Do as follow:

Send 'APN' to the SIM card in the control panel; you'll get a message back.

Forward and fill in related APN, username and password,, then send it back. You'll get a message 'OK' from the SIM card in the control panel to notify you that the setting is successful. Turn off the panel and restart, then you can operate the APP via GPRS freely.

For instance, for SIM card from Vodafone in Netherlands, there is no username and password, leave it as it is. A message replied 'OK', means the setup is successful.

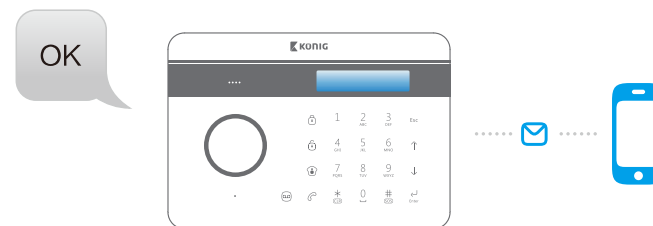
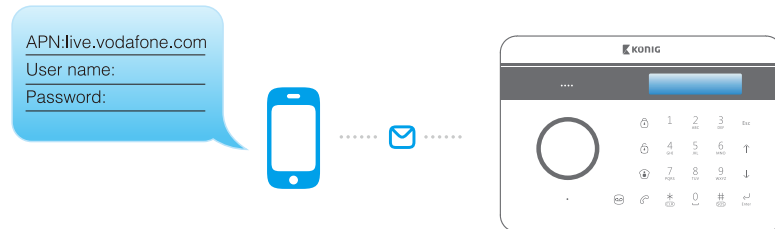
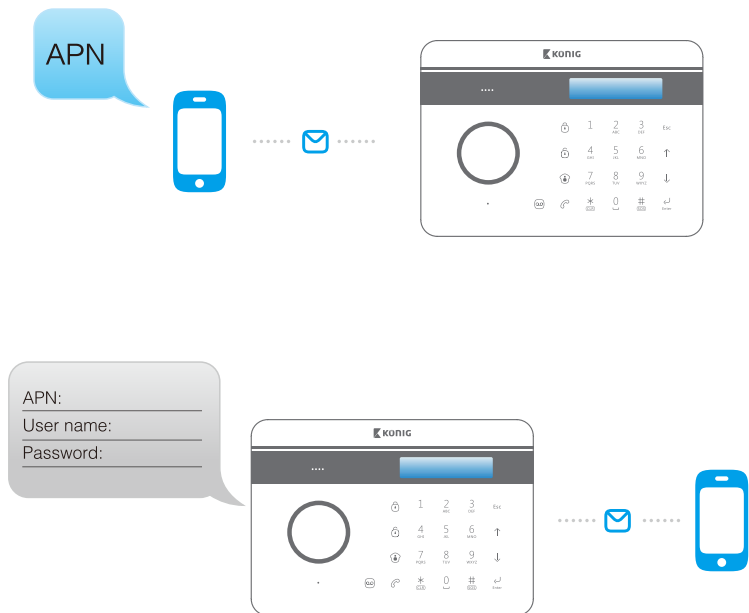

Note: The APN setting varies in different countries. Consult the local operator on how to set the APN correctly.

1. Register

Registering account enables you to bind the alarm systems to your smart phone.

① Enter login interface

Tap B11 APP, choose [GPRS], and then the login interface appears.



② Register an account

Tap [Register], input your mobile number, password, device ID, random code (SN code on the back side of the panel), and then tap [OK].

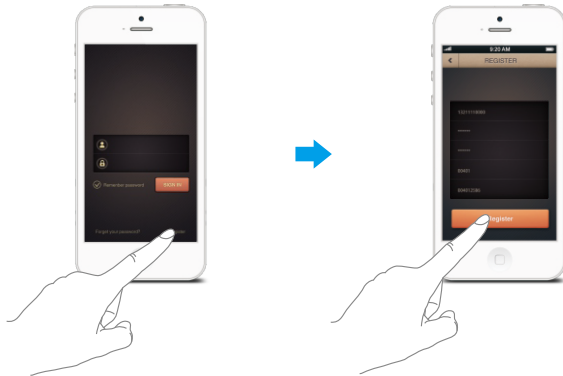

Note: When register, please input user's mobile number instead of the SIM card number of the control panel. The device ID, random code are shown on the back side of the control panel, please keep it properly for safety.

2. Operations on main menu

Login to enter the main menu, user can perform disarm, arm, home arm, monitor and leave voice memo.

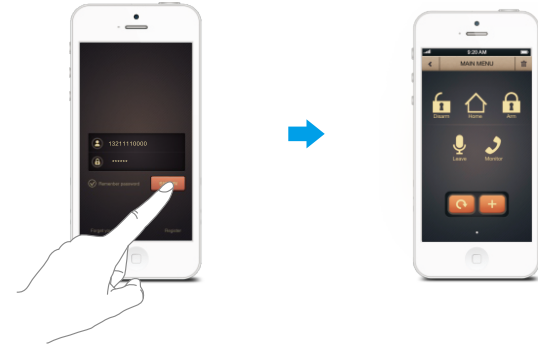

3. Delete accounts

Press [] on the main menu after login, tap [OK] on the dialog box to confirm deletion.





4. Refresh

Press  to refresh the current system state.



5. Add family accounts

Press  to enter the account management interface, and input family member's mobile number as their login name, tag . The default password of family account is 123456, user can change it when login.

The main account can add at most 5 family accounts. Family accounts can be deleted by tapping the  on the right side in the accounts list.

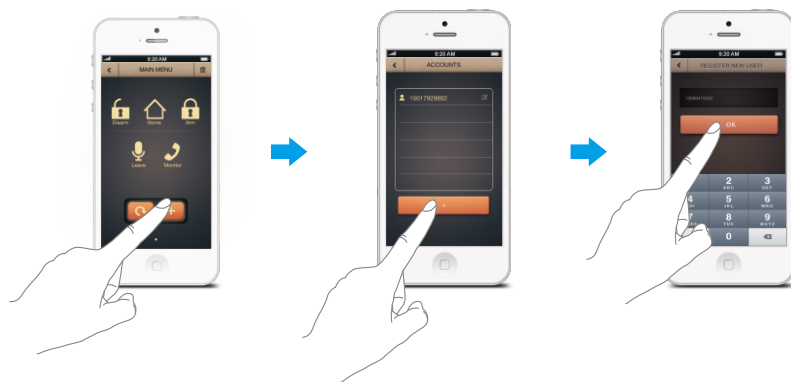

Maintenance

The alarm system features unique and brilliant design and craftwork. Please use it with caution. The following suggestions will help prolong the service life of the system.

- 1 Keep this product and accessories out of children's reach.
- 2 Keep the product and accessories dry. Rainwater, moisture and liquids are likely to contain minerals that will corrode electronic circuits.
- 3 Do not use or store the alarm system in dusty or dirty places; otherwise it may damage the electronic components.
- 4 Do not expose the alarm system to high temperature. High temperatures can shorten the life of electronic components, damage batteries, and cause melting and deformation of plastic parts.
- 5 Do not store the alarm system in cold areas. Otherwise, when the temperature of the alarm system rises to the normal level, moisture appears inside, damaging PCB.
- 6 Test the alarm system regularly and perform troubleshooting in time.
- 7 Check the built-in batteries of accessories regularly. If the batteries are low, replace with new ones.
- 8 The alarm system requires uninterrupted power supply for working or standby. Therefore, you need to connect the AC adapter to a reliable power outlet.
- 9 Avoid placing the control panel and sirens in bedrooms or offices, so as not to disturb your rest or work.
- 10 It is recommended to cut off the power if the system is not used for long time.
- 11 If the alarm system is covered with dirt, wipe off the dirt with soft cloth or tissue. For stains, apply diluted alkaline detergent to soft cloth, wring the cloth out and wipe the product. Then, dry the product with dry absorbent cloth.

Please carefully read and strictly follow the previous suggestions. If the product remains faulty, you can send it to the place of purchase or authorized maintenance center for maintenance. We will provide help as soon as possible.

FAQ

Issue	Cause of Malfunction	Solution
No response from control panel operation	Power switch is off	Open battery compartment, turn on the power
	AC Power failure	Contact local main power supply bureau
	Lithium battery backup power exhausted	Connect to main power with adapter
Accessories cannot connect to control panel	Panel not in learning status	Make sure the panel set in learning status
	Accessories not triggered for learning	Make sure the triggered accessories transmitting signal to panel for learning
	The control panel has different radio frequency with accessories.	Please contact retailer for help
No response from the control panel by operating remote control	Remote control is not learned to control panel	Follow the manual and connect the remote control to panel
	Out of range between remote control and panel	Remote control the panel in proper distance
		Signal repeater could be added
RFID card/tag fail to disarm	RFID card/tag not connected to the panel	Follow the manual and connect RFID card/tag to the panel
Touch keyboard fail to make related setting	Not logged onto the setting menu.	Input the correct admin code, press [Enter] and log on menu setting
No response after inserting a SIM card.	The direction of the SIM card is not correct.	Please insert the SIM card again according to the user manual.
	Switch on the control panel first and then insert the SIM card.	Insert the SIM card first and then switch on the control panel.
	The SIM card is not a GSM SIM card	Please use GSM SIM card.
APP replied" Return data run out"	Please check the network of control panel and mobile phone.	Make sure the network works properly
APP replied "Control panel offline"	Please check the network of control panel	Make sure the SIM card of control panel is not indebted.

Specifications

SAS-ALARM300 Control Panel

Power Supply	Input DC 12V 500mA, 6Wh
Standby Current	≤ 90mA
Alarm Current	≤ 300mA
Backup Battery	BL-5B 3.7V 800mAh rechargeable lithium battery x 2 pcs
Internal Siren Volume	95dB
Radio Frequency	433.92MHz (±75KHz)
Maximum Stored Phone No.	6 alarm phone numbers and 2 CMS numbers
Maximum Remote Controls	10 pcs
Maximum Sensors	50 pcs
Maximum RFID Tags	50 pcs
Maximum Event Logs	150 events
Housing Material	ABS plastic
Operating Condition:	Temperature -10°C~ +55°C
	Relative Humidity ≤ 80% (non-condensing)
Dimensions (L x W x H)	185 x 130 x 27mm

SAS-ASRC300 Wireless Remote Control

Power Supply	DC 3V (CR2025 Lithium Battery x 1pc)
Alarm Current	≤ 7mA
Transmitting Distance	≤ 80m (in open area)
Radio Frequency	433 92MHz (± 75KHz)
Housing Material	ABS plastic
Operating Condition:	Temperature -10°C~+55°C
	Relative Humidity ≤80% (non-condensing)
Dimensions (L x W x H)	58 x 31 x 9.5mm

SAS–ASDW300 Wireless Door/Window Contact

Power Supply	DC 1.5V (AA 1.5V LR6 Battery x 1 pc)
Static Current	≤ 35uA
Alarm Current	≤ 10mA
Transmitting Distance	≤80m (in open area)
Radio Frequency	433.92MHz (±75KHz)
Housing Material	ABS plastic
Operating temperature	Temperature -10°C~+55°C Relative humidity ≤80% (non-condensing)
Transmitter Dimensions (L x W x H)	71 x 34 x 17.5mm
Magnet Dimensions (L x W x H)	51 x 12 x 13.5mm

SAS–ASMS310 Pet–Immune PIR Motion Detector

Power Supply	DC 3V (AA 1.5V LR6 Battery x 2 pcs)
Static Current	≤ 90uA
Alarm Current	≤ 9.5mA
Detection Scope	8m/110°
Pet Immunity	≤ 25kgs
Transmitting Distance	≤ 80m (in open area)
Radio Frequency	433.92MHz (± 75KHz)
Housing Material	ABS plastic
Operating Condition	Temperature -10°C~55°C Relative humidity ≤80% (non-condensing)
Detector Dimensions (L x W x H)	108 x 52 x 36.8 mm
Bracket Dimensions (L x W x H)	52 x 30 x 26.5 mm

SAS–ASRT300 RFID TAG

Internal Circuit	EM4100 CMOS
Working Frequency	125KHz
Housing Material	Compound Plastic
Dimension	30 x 30 x 6mm

Disclaimer

Dear users:

We has reviewed this manual thoroughly in order that it will be an easy to use guide to this product. All statements, technical information, recommendations in this manual are believed reliable, but the accuracy and completeness thereof are not guaranteed or warranted.

The specifications and information regarding the products in this document are subject to change without notice.

Photocopy, copy, reproduction, translation to any language, modification, storage in a retrieval system or retransmission, in any form or by any means, electronic, mechanical or otherwise, is strictly prohibited without prior written permission.

In no event we are liable for any indirect, special, incidental, or consequential damages, including, without limitation, lost profits or loss or damage to data arising out of the use or inability to use this document, even if the product has been advised of the possibility of such damages.

