

# LIFT30 product information sheet



Raise your TV to fit your life! The LIFT30 allows you to raise or lower your TV to the ideal position for watching movies, gaming, exercising and more. The LIFT30 is equipped with Ergotron's patented Constant Force technology, providing fluid, light-touch adjustments for tilt and vertical movement. LIFT30 remains virtually hidden as TV glides up and down. Sit. Stand. Stretch. Play – all at the perfect height and angle.

## Product Benefits\*

- Lift and lower your TV to achieve the best picture and sound
- Move with only a light touch; no knobs or levers required
- Ideal for multipurpose rooms and TV activities
- Post-installation leveling
- Includes complete hardware kit for easy installation

## Product Specifications\*

**Fits most:** 27–40" (69–101 cm) TVs

**Supports:** 12–30 lbs (5.4–13.6 kg)

**Mounting profile:** 2.7" (6.9 cm)

**Vertical movement:** 10" (25.4 cm)

**VESA compliance:** 100x100 to 400x400

**Mounting:** Single-stud or solid wall

**Warranty:** 5 years

**Color:** Black

## Series



LIFT30



LIFT30X



LIFT50



LIFT70



Ergotron's Constant Force technology makes moving a TV up or down simple, requiring only a light touch.

\*Subject to change

**800.MOUNT.IT (800.668.6848)**

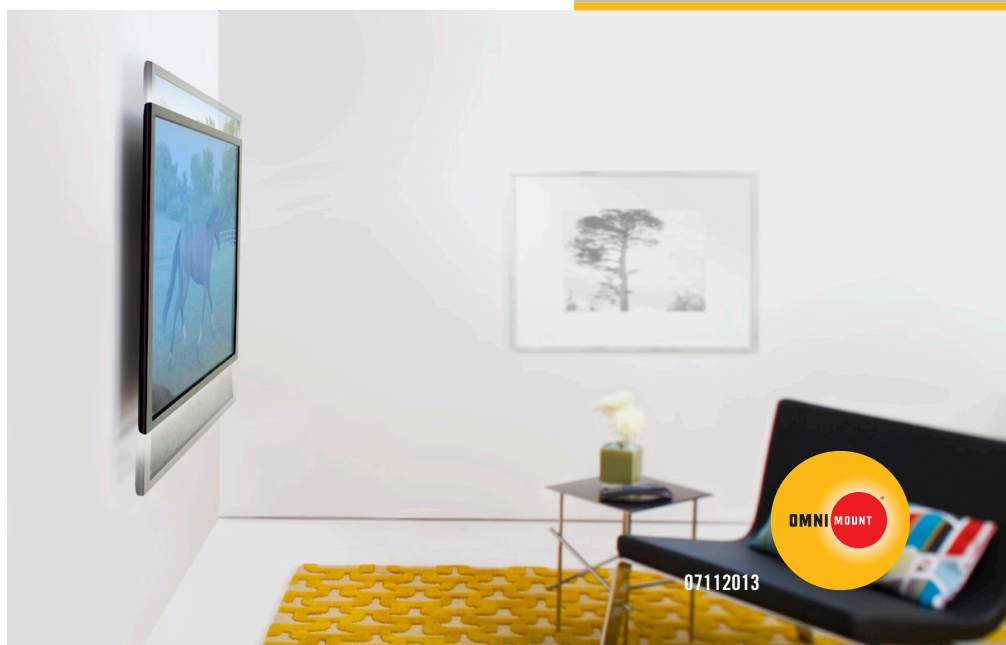

07112013

# LIFT30 technical data sheet

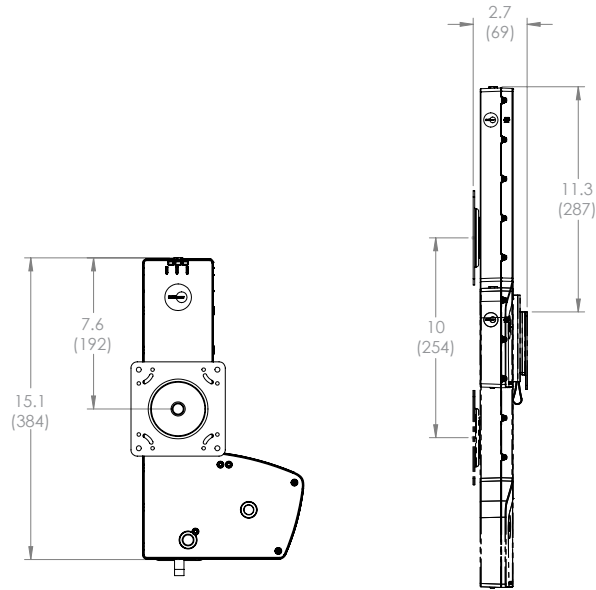

FRONT VIEW

SIDE VIEW

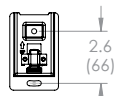

WALL MOUNT BRACKET

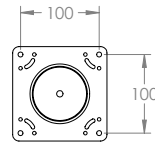

VESA PLATE (mm)

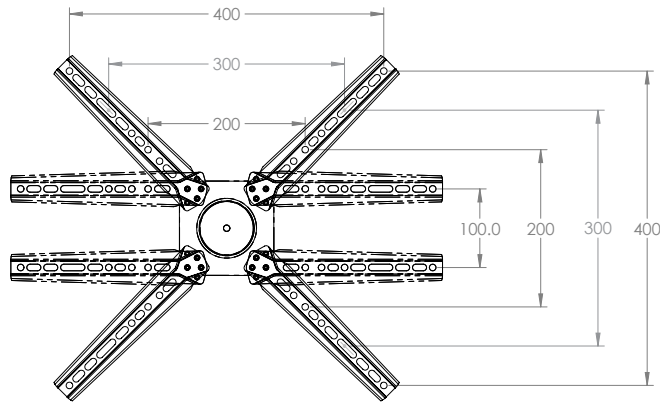

VESA PLATE WITH ADAPTERS (mm)

inches (mm)

	Packaging UPC	MC UPC
Americas	698833039887	10698833039884
International	698833039887	10698833039884

	Dimensions WxDxH Inches (mm)	Wt lbs (kg)	Qty
Box	19.3 x 11.8 x 4.1 (490x299x104)	7.9 (3.6)	NA
MC	19.7 x 12.4 x 9.3 (501x314x235)	16.9 (7.7)	2

Box Contents	Qty
Wall plate	1
Lift assembly	1
400mmx400mm adapter	4

Box Contents	Qty
Instruction manual	1
Complete hardware kit	1

